

# 150 Directional Cowl & Flashing Detail

## 150 Directional Cowl

Fire, Flue System to Comply with ASNZS 2918:2001

**Due to continued product improvement, Warmington Ind LTD reserves the right to change product specifications without prior notification.**

Read all the Instructions carefully before commencing the Installation. Failure to follow these instructions may result in a fire hazard and void the warranty

For Specification See: [www.warmington.co.nz](http://www.warmington.co.nz)

Copyright ©

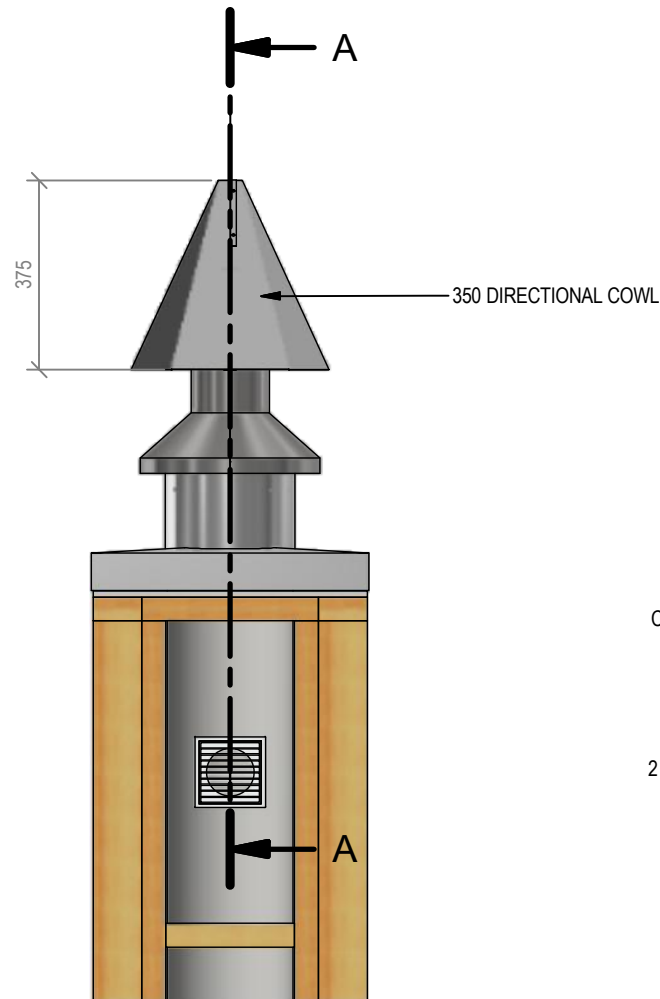

A-A

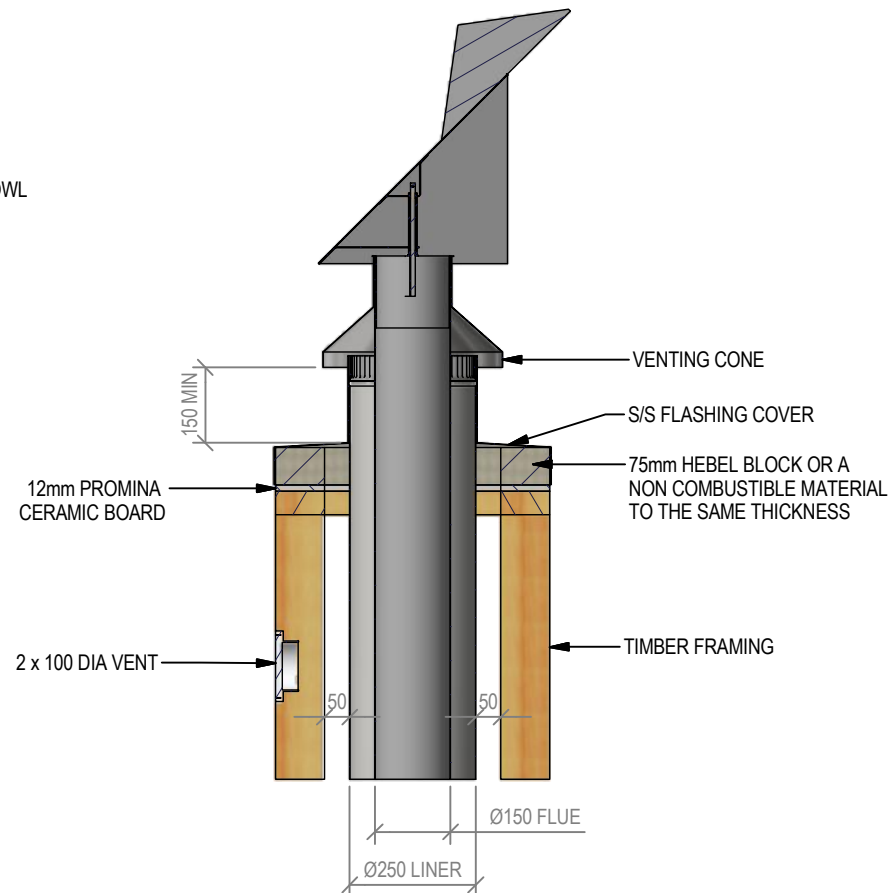

<b>Warmington Industries Ltd.</b>			
PH: 09 273 9227 FAX: 09 273 9241 WEB: <a href="http://www.warmington.co.nz">www.warmington.co.nz</a>			
TITLE	150 DIRECTIONAL COWL & FLASHING DETAIL	DATE	04/10/2021
DRAWN	Everest	REVISION	01
SCALE	NOT TO SCALE		

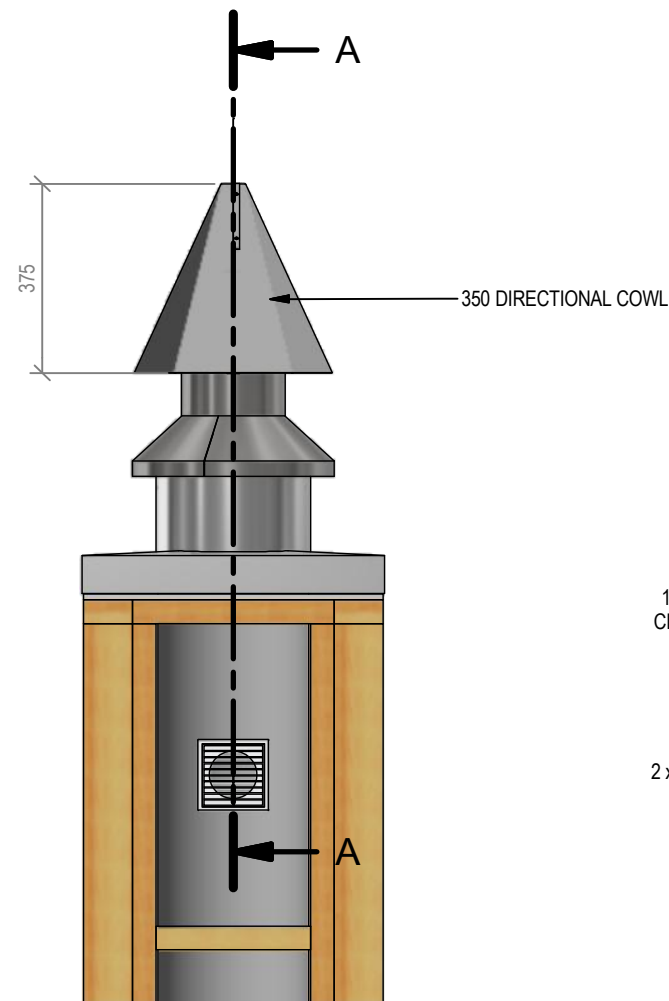

## 200 Directional Cowl

Copyright ©

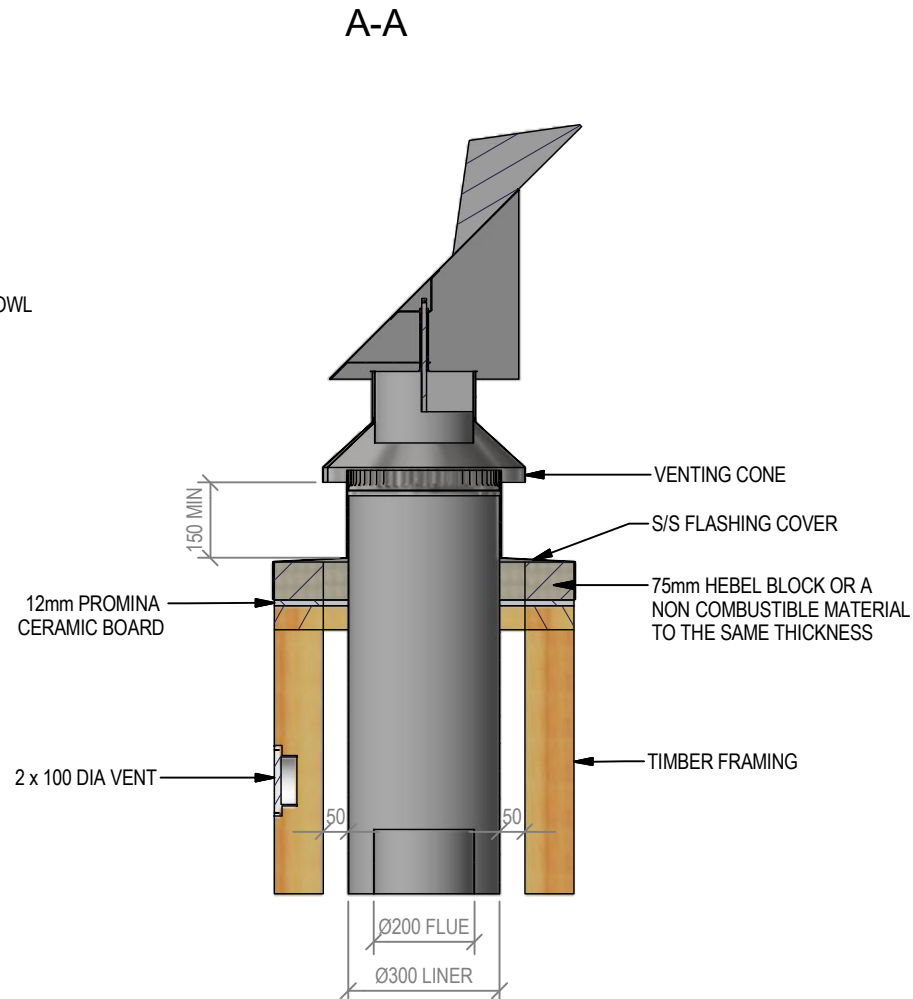

<b>Warmington Industries Ltd.</b> PH: 09 273 9227 FAX: 09 273 9241 WEB: <a href="http://www.warmington.co.nz">www.warmington.co.nz</a>	
TITLE 200 DIRECTIONAL COWL & FLASHING DETAIL	
DRAWN Everest	DATE 04/10/2021
SCALE NOT TO SCALE	REVISION 01

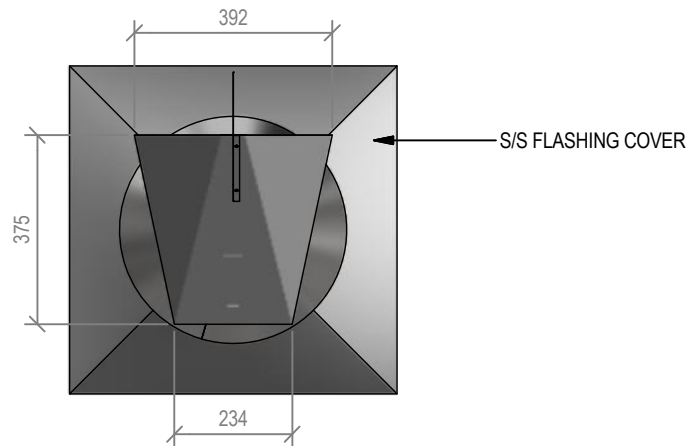

## 250 Directional Cowl & Flashing Detail

### 250 Directional Cowl

Fire, Flue System to Comply with ASNZS 2918:2001

**Due to continued product improvement, Warmington Ind LTD reserves the right to change product specifications without prior notification.**

Read all the Instructions carefully before commencing the Installation. Failure to follow these instructions may result in a fire hazard and void the warranty

For Specification See: [www.warmington.co.nz](http://www.warmington.co.nz)

Copyright ©

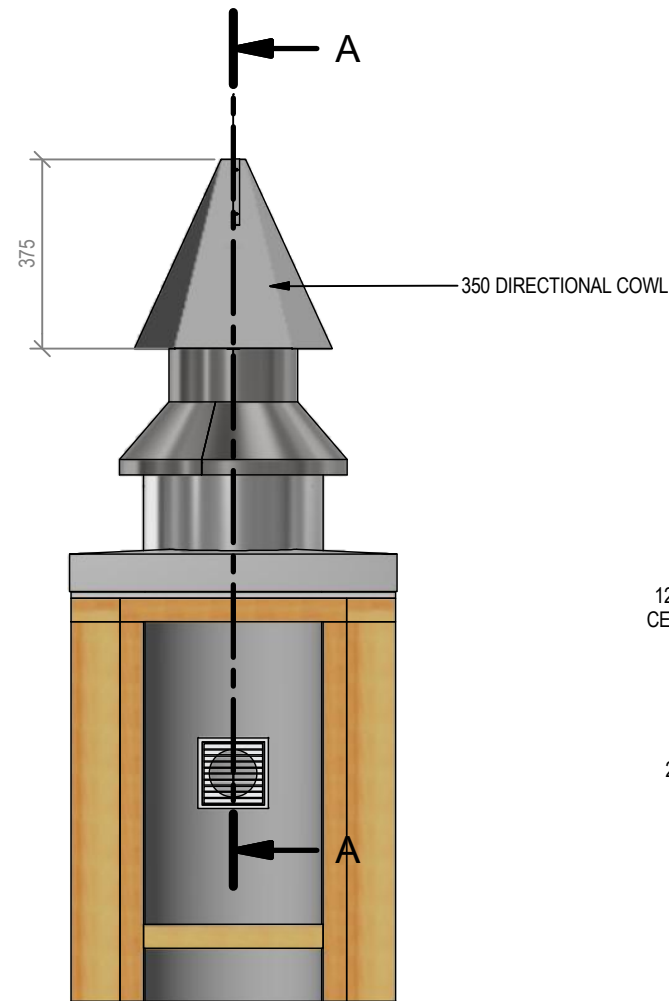

A-A

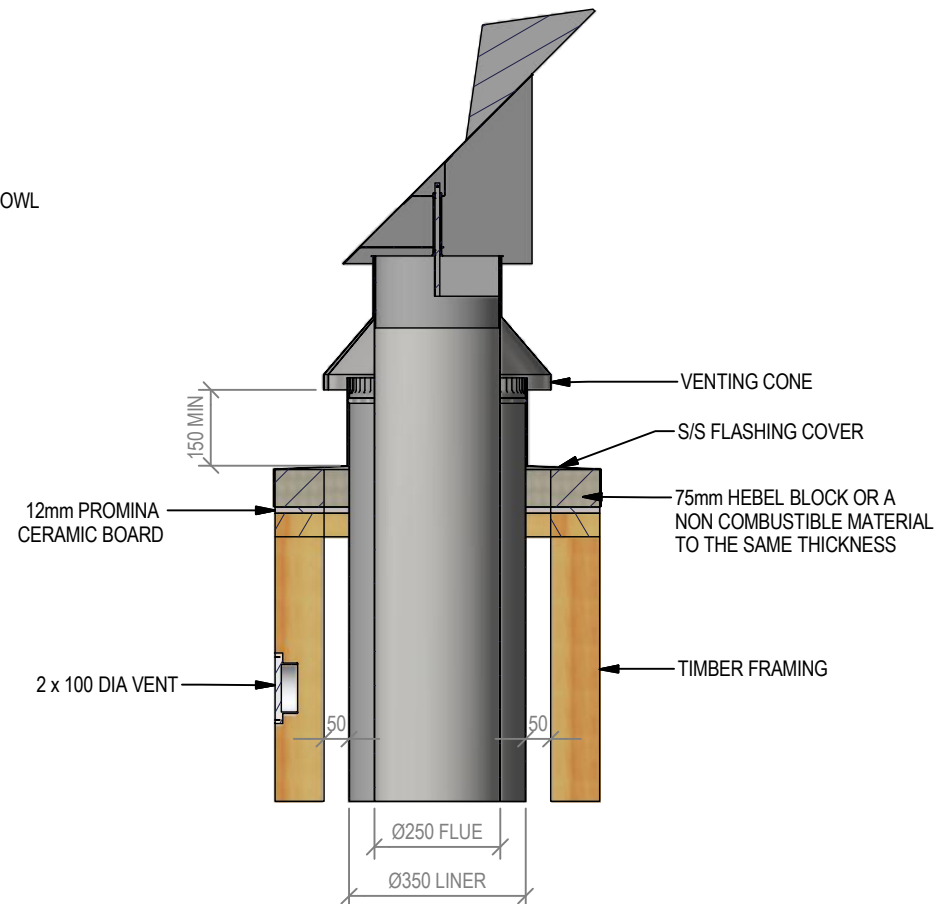

<b>Warmington Industries Ltd.</b>			
PH: 09 273 9227 FAX: 09 273 9241 WEB: <a href="http://www.warmington.co.nz">www.warmington.co.nz</a>			
TITLE	250 DIRECTIONAL COWL & FLASHING DETAIL		
DRAWN	Everest	DATE	28/09/2021
SCALE	NOT TO SCALE	REVISION	01

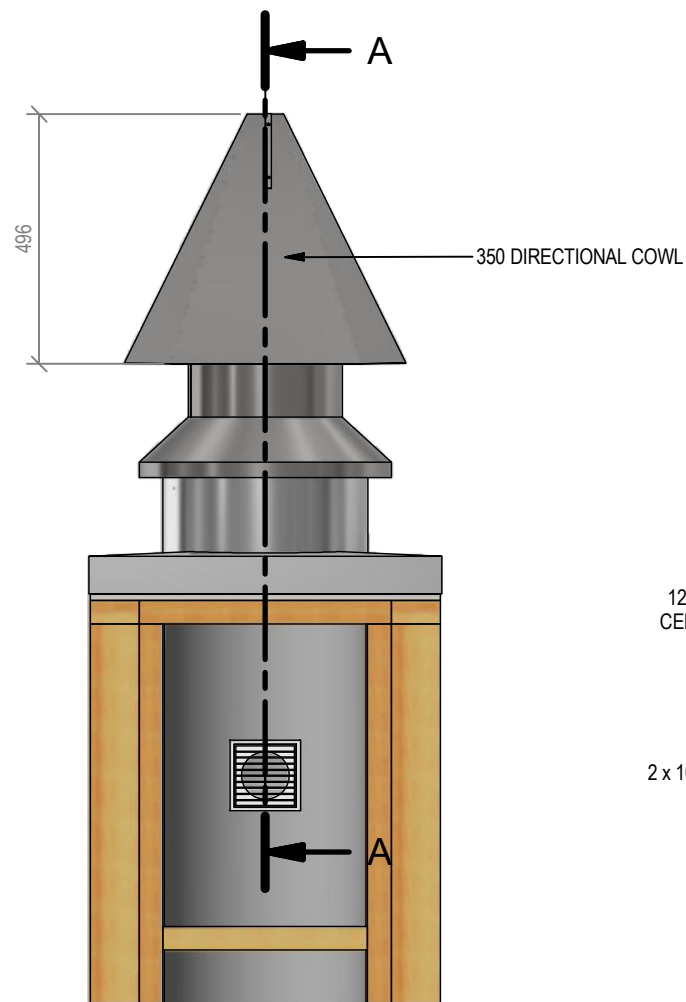
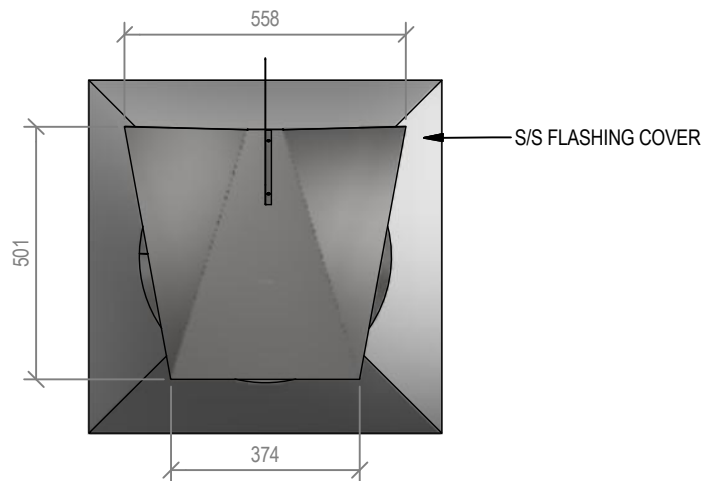

## 300 Directional Cowl & Flashing Detail

### 300 Directional Cowl

Fire, Flue System to Comply with ASNZS 2918:2001

**Due to continued product improvement, Warmington Ind LTD reserves the right to change product specifications without prior notification.**

Read all the Instructions carefully before commencing the Installation. Failure to follow these instructions may result in a fire hazard and void the warranty

For Specification See: [www.warmington.co.nz](http://www.warmington.co.nz)

Copyright ©

A-A

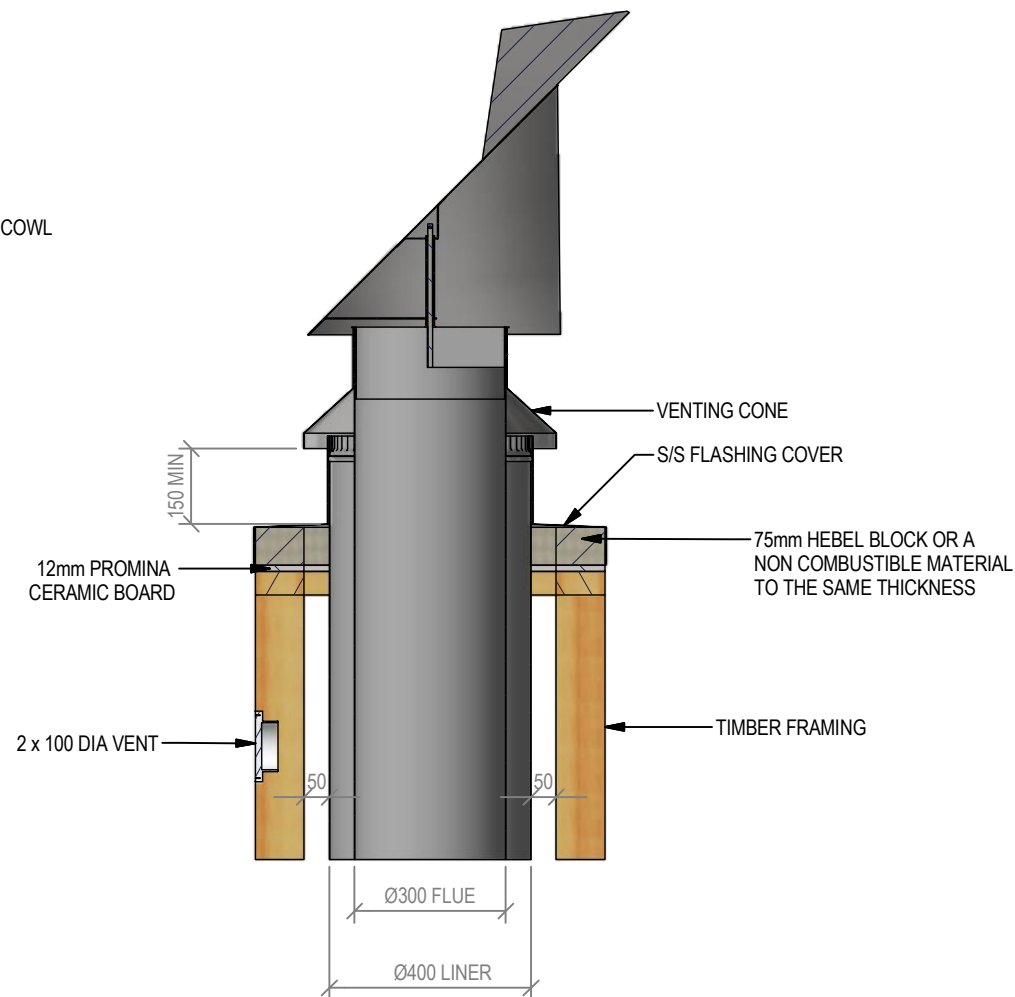

<b>Warmington Industries Ltd.</b>			
PH: 09 273 9227 FAX: 09 273 9241 WEB: <a href="http://www.warmington.co.nz">www.warmington.co.nz</a>			
TITLE	300 DIRECTIONAL COWL & FLASHING DETAIL	DATE	28/09/2021
DRAWN	Everest	REVISION	01
SCALE	NOT TO SCALE		

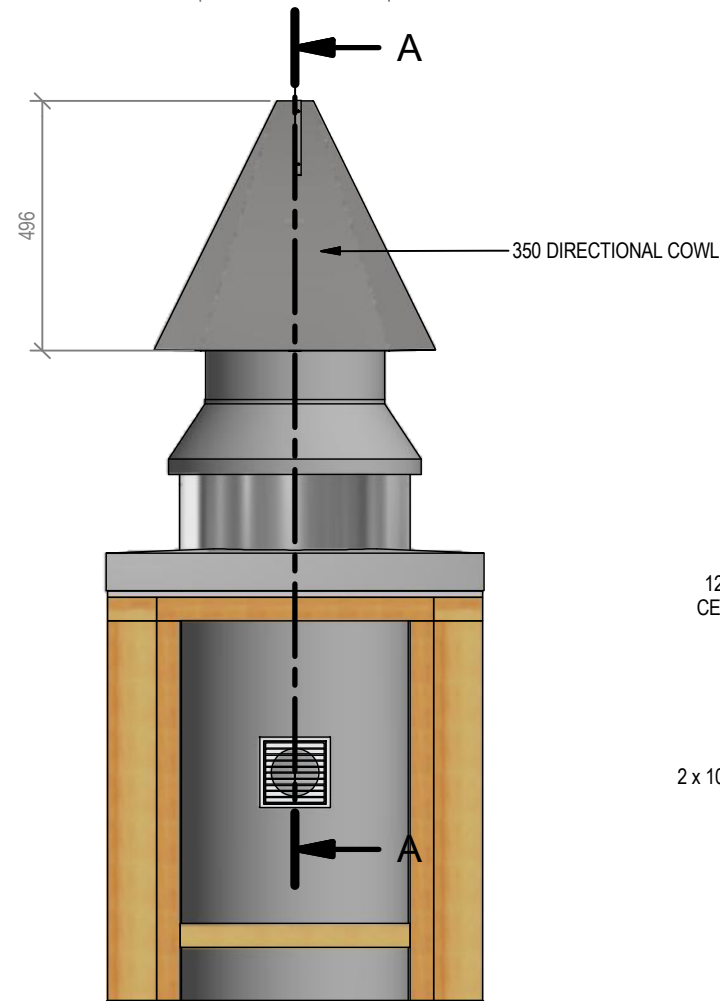
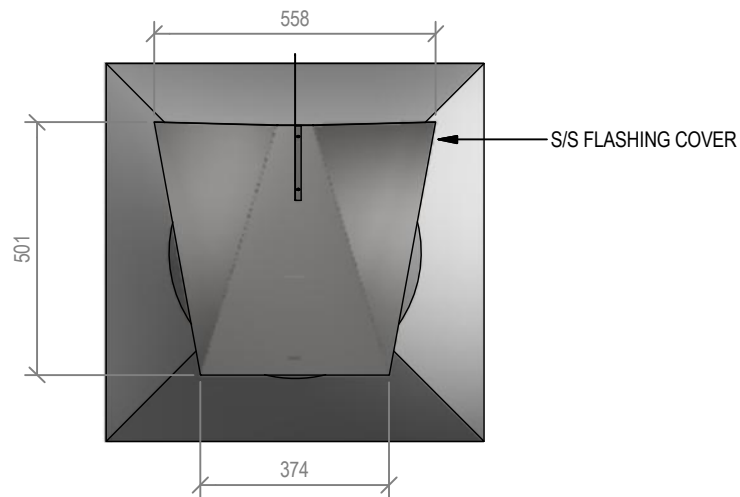

# 350 Directional Cowl & Flashing Detail

## 350 Directional Cowl

Fire, Flue System to Comply with ASNZS 2918:2001

**Due to continued product improvement, Warmington Ind LTD reserves the right to change product specifications without prior notification.**

Read all the Instructions carefully before commencing the Installation. Failure to follow these instructions may result in a fire hazard and void the warranty

For Specification See: [www.warmington.co.nz](http://www.warmington.co.nz)

Copyright ©

A-A

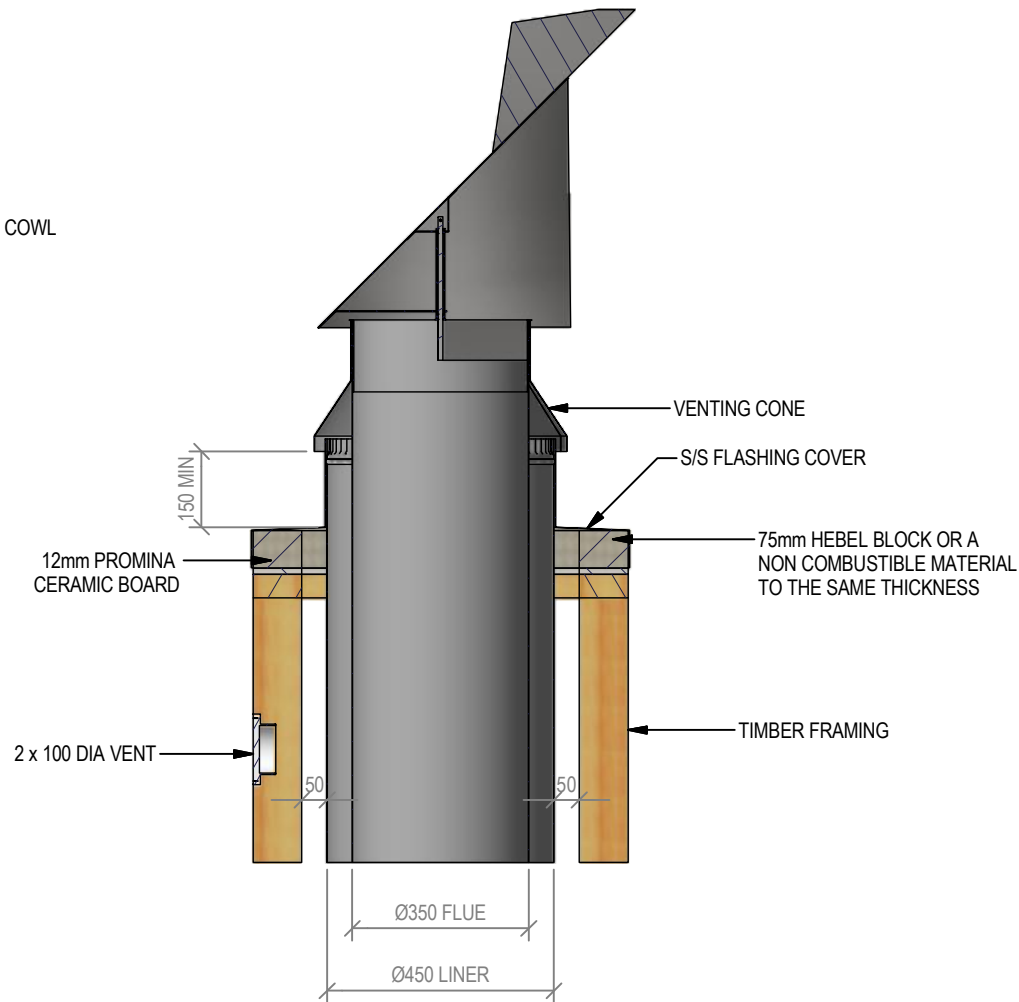

Warmington Industries Ltd.			
PH: 09 273 9227 FAX: 09 273 9241 WEB: <a href="http://www.warmington.co.nz">www.warmington.co.nz</a>			
TITLE	350 DIRECTIONAL COWL & FLASHING DETAIL		
DRAWN	ROBERT	DATE	01/07/13
SCALE	NOT TO SCALE	REVISION	02

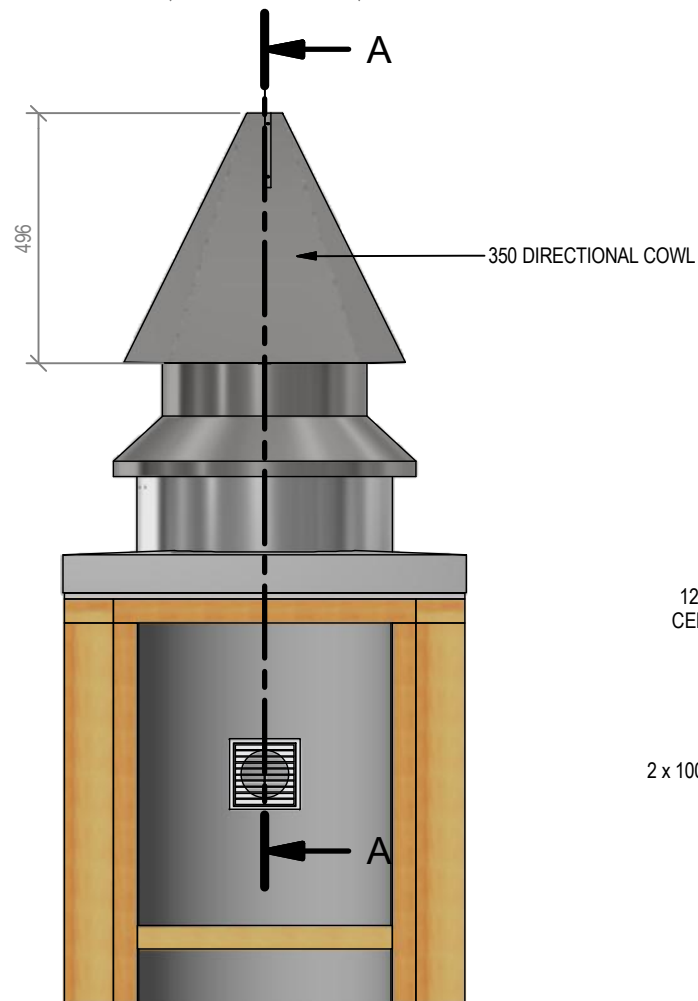
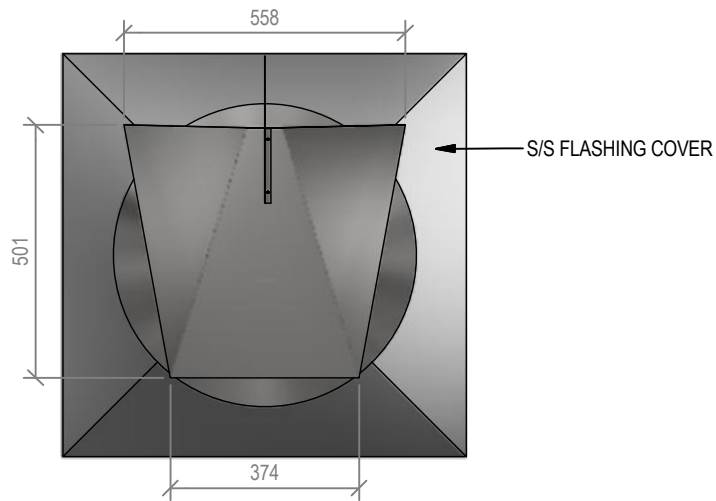

# 400 Directional Cowl & Flashing Detail

## 400 Directional Cowl

Fire, Flue System to Comply with ASNZS 2918:2001

**Due to continued product improvement, Warmington Ind LTD reserves the right to change product specifications without prior notification.**

Read all the Instructions carefully before commencing the Installation. Failure to follow these instructions may result in a fire hazard and void the warranty

For Specification See: [www.warmington.co.nz](http://www.warmington.co.nz)

Copyright ©

A-A

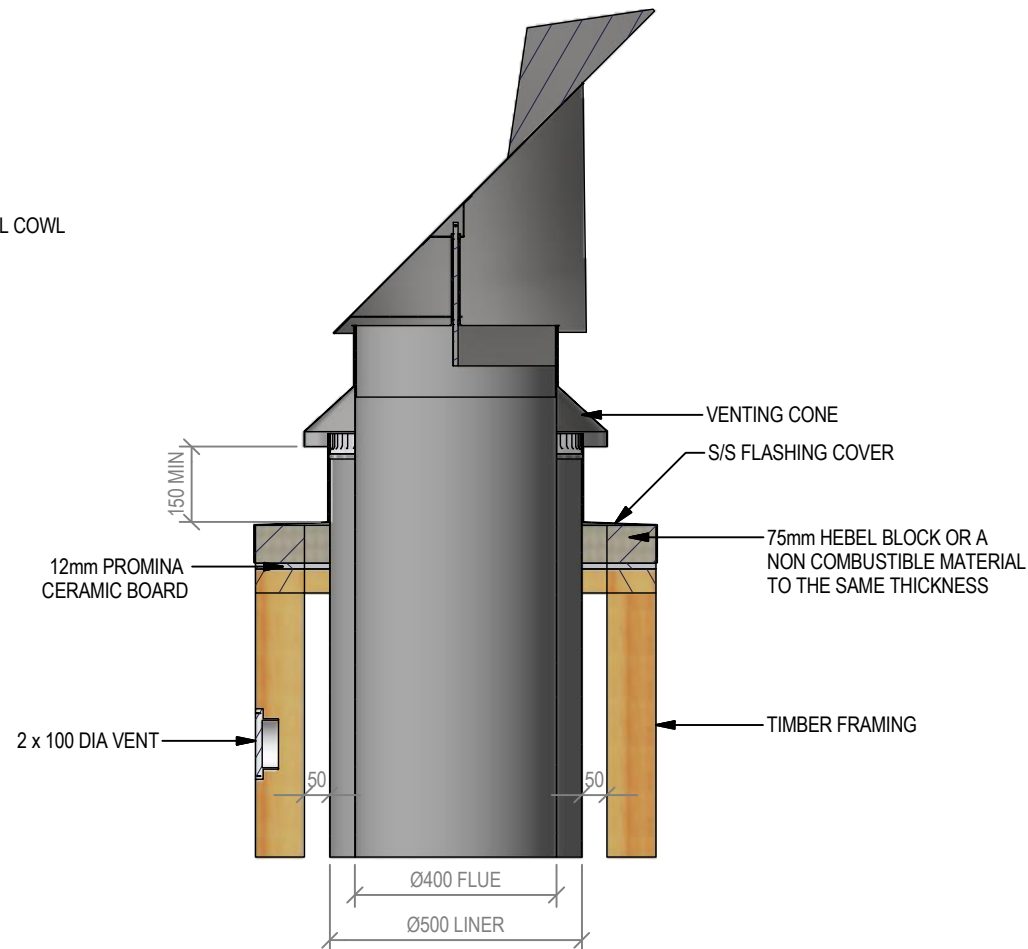

Warmington Industries Ltd.			
PH: 09 273 9227 FAX: 09 273 9241 WEB: <a href="http://www.warmington.co.nz">www.warmington.co.nz</a>			
TITLE	400 DIRECTIONAL COWL & FLASHING DETAIL	DATE	28/09/2021
DRAWN	Everest	REVISION	01
SCALE	NOT TO SCALE		