

Warmington Evoque 1300

Maintenance and Operating Instructions



How to light and maintain your Evoque Open Wood fire

Please keep these instructions for future reference

Manufactured by Warmington Industries, 47 Sir William Ave, East Tamaki, Auckland.
PO Box 58 652, Botany 2163
Telehpone: 09 273 2997 Fax: 09 271 1892 www.warmington.co.nz
Email: info@warmington.co.nz

Due to continued product improvement, Warmington Ind LTD reserves the right to change product specifications without prior notification.

FOR CORRECT OPERATION OF YOUR OPEN WOOD FIRE

These are guidelines only as each installation has it's own unique aspects.

Using the handle, open the screen (see Dia 1.) and place a generous amount of crumpled newspaper on top of the grate. Place a dozen or so, pieces of finely split kindling on top and behind the paper. You can place fire-lighters under the newspaper to help sustain the fire, if you wish.

Dia 1.

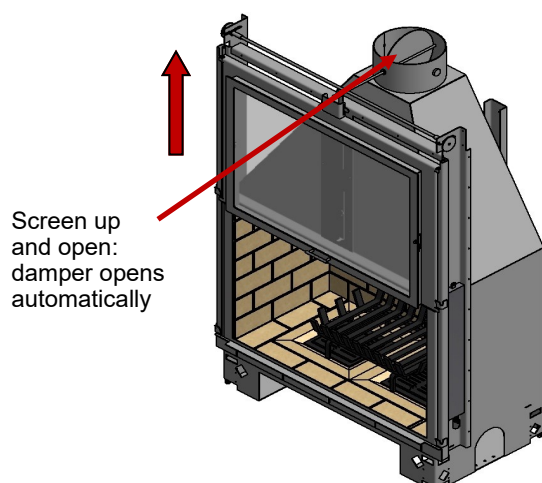

Light the paper and/or firelighters from both ends and the middle. As soon as the kindling has 'caught' and is burning briskly, add smallish pieces of wood to the fire. When the fire is established, put on larger pieces in a criss-cross pattern.

You may notice a faint smell on the first light of the fire. This is the paint coat curing and this smell will soon disappear.

Dia 2.

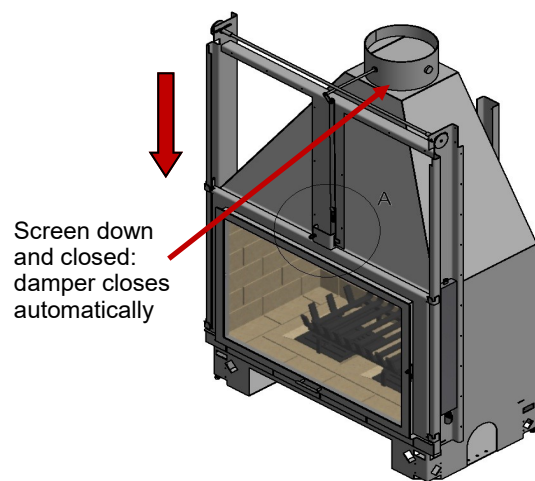

You can continue to operate the fire safely with the screen in the up position, or if the fire is left unattended you can lower the screen to guard against any possible embers sparking out of the fireplace. This will automatically close the flue damper and slow the rate of combustion.

IMPORTANT: You must always use the supplied grate and safely load the fire with the correct amount of firewood (maximum 5kg). This open fire has been tested to 2918 and you run the risk of overfiring if the fire is overloaded and the warranty may also be voided if these instructions are not followed.

GRATE

Description		GRATE
Grate Depth	V	410
Grate Width	W	605
Grate Height	X	195

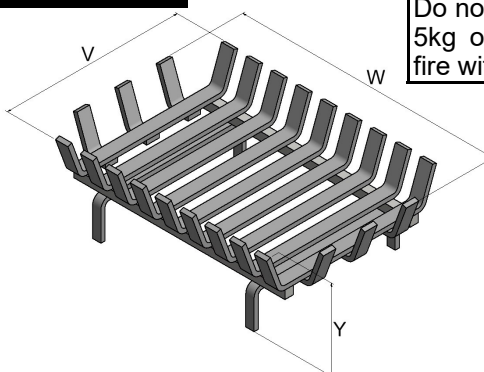

Important Note:

Do not load the fire with more than 5kg of softwood. Do not use the fire without the supplied grate.

Due to continued product improvement, Warmington Ind LTD reserves the right to change product specifications without prior notification.

Presetting and changing the setting of the damper control

You can control the fire with the damper settings. The preset control handle is located on the top of the firebox, above the screen. The control allows you to preset the minimum opening of the damper, when the screen is closed. This adjusts the burn rate, as it restricts the flow of combustion air to the fire.

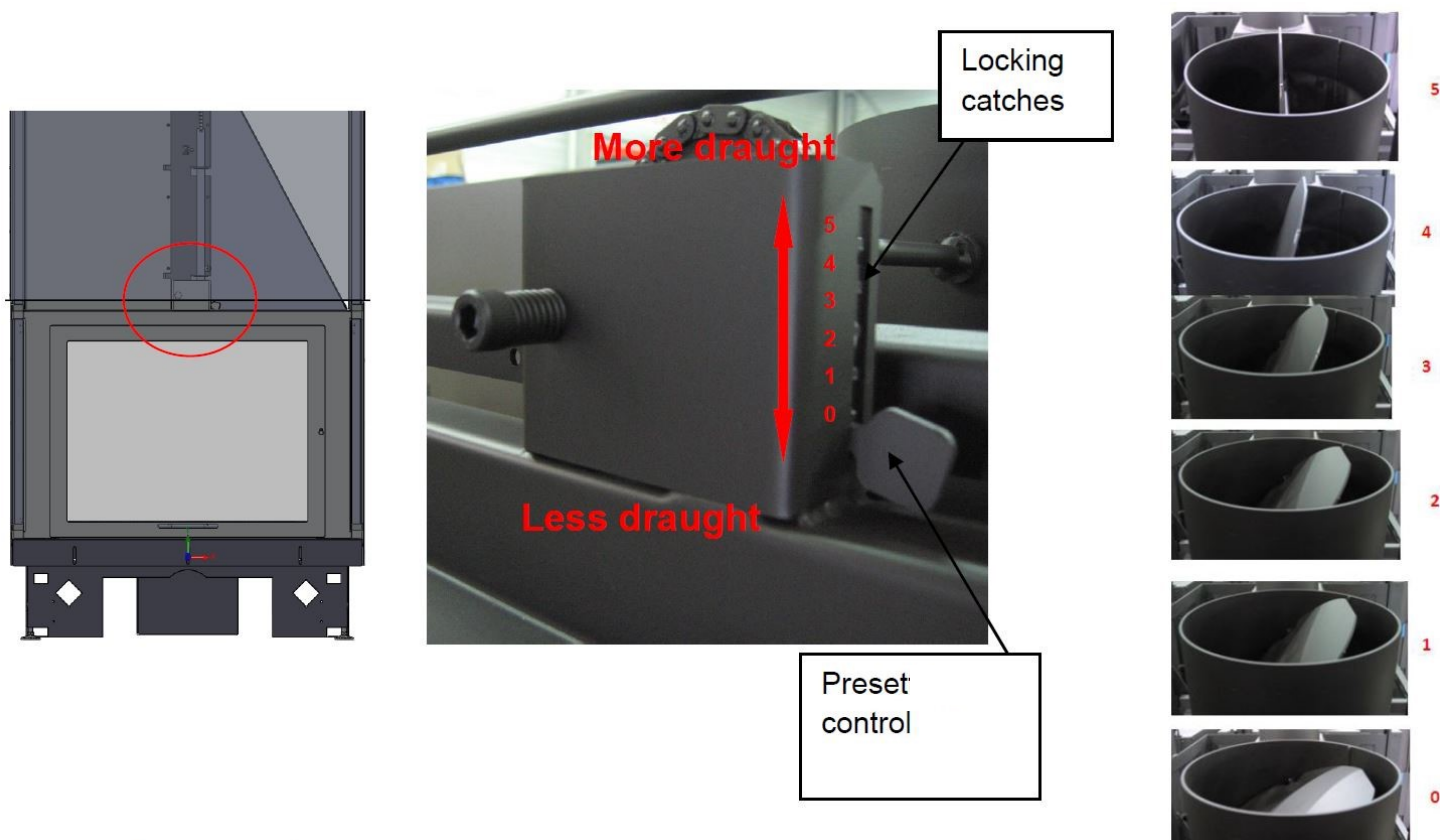

1. Push the preset control handle in order to disengage it from its catches.
2. Keeping it pushed in, slide up or down in order to obtain the desired setting:
 - Preset control upwards = trap more open ↑ increased draught.
 - Preset control downwards = trap more closed ↓ decreased draught.
3. Once you have obtained the desired position, release the control.
4. When using the appliance for the first few times, it will be necessary to set the damper trap according to the natural draught of your chimney. This is unique to each individual install.

Due to continued product improvement, Warmington Ind LTD reserves the right to change product specifications without prior notification.

BAFFLE POSITION

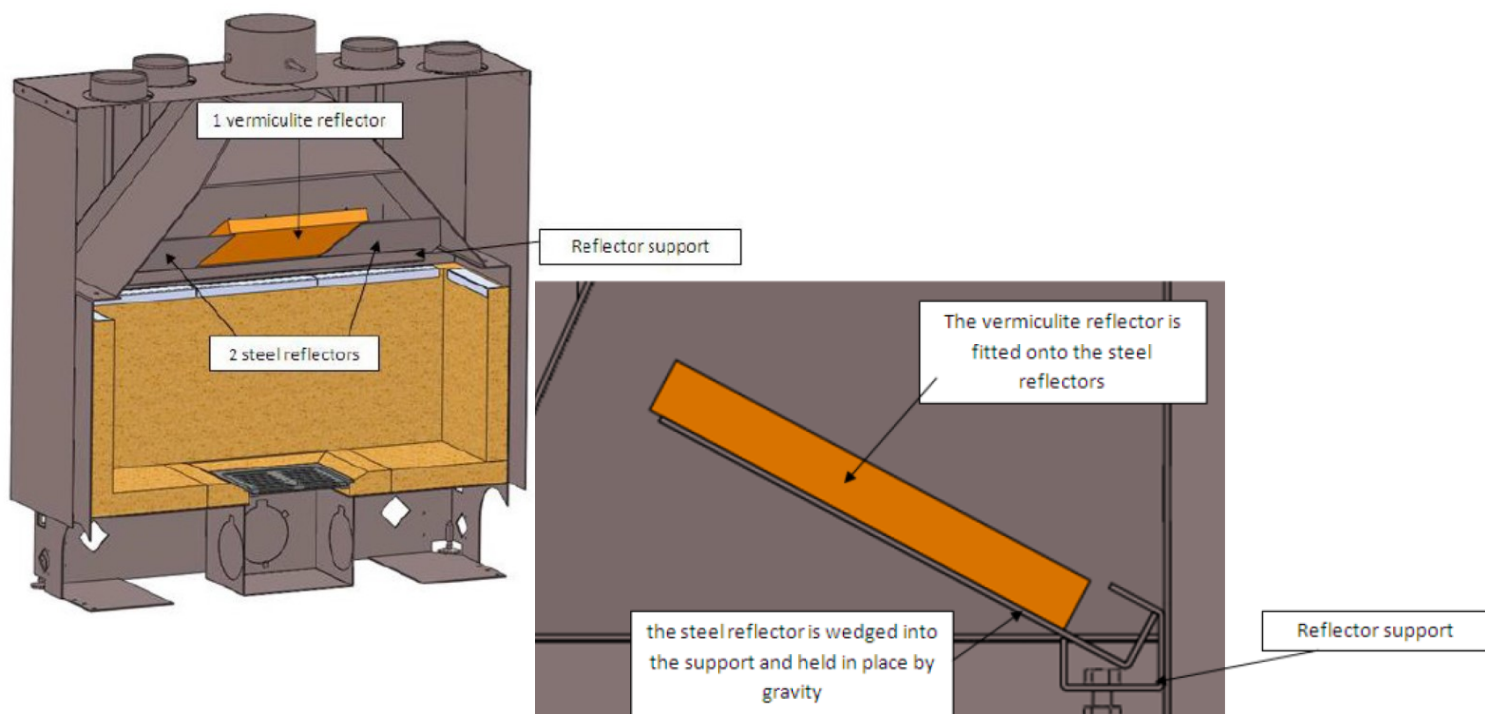

CHAIN AND SPROCKET ACCESS CHANNEL

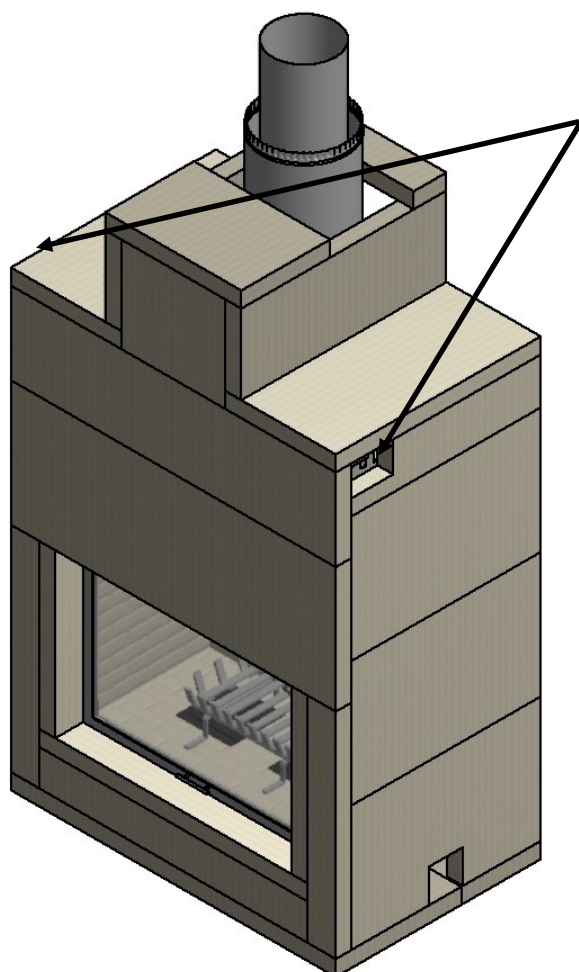

Location of the sprocket and chain access panel.
This must be accessible for servicing, maintenance and lubrication on both sides.

Ensure that the Warmington and flue system is swept annually or more frequently if required. To sweep flue and firebox:

Cover front of fire with sheets, or keep screen closed during.
Remove cowl from top of chimney.
Sweep from the top, down the flue.
Remove all soot and ash.
Ensure cowl and bird protection is clean and replaced.
Visually inspect fireplace and flue system.

Due to continued product improvement, Warmington Ind LTD reserves the right to change product specifications without prior notification.

GENERAL NOTES: ASNZS 2918: 2001**NOTES:**

- Correct installation and operation must be maintained to comply with Warmington warranty.
- The appliance and flue system must be installed in accordance with ASNZS2918:2001 and the appropriate building codes.
- The fire must be serviced and the flue system and fireplace is to be swept annually, or more frequently if required.

Important Note:

Do not load the fire with more than 5kg of softwood. Do not use the fire without the grate.

WARNINGS:

- **WARNING: ANY MODIFICATION OF THE APPLIANCE THAT HAS NOT BEEN APPROVED IN WRITING BY THE TESTING AUTHORITY IS CONSIDERED AS BREACHING AS/NZS 4013.**
- **WARNING: DO NOT USE FLAMMABLE LIQUIDS OR AEROSOLS TO START OR REKINDLE THE FIRE.**
- **WARNING: DO NOT USE FLAMMABLE LIQUIDS OR AEROSOLS IN THE VICINITY OF THIS APPLIANCE WHEN IT IS OPERATING.**
- **WARNING: DO NOT STORE FUEL WITHIN HEATER INSTALLATION CLEARANCES.**
- **CAUTION: THIS APPLIANCE SHOULD BE MAINTAINED AND OPERATED AT ALL TIMES IN ACCORDANCE WITH THESE INSTRUCTIONS**
- **CAUTION: THE USE OF SOME TYPES OF PRESERVATIVE-TREATED WOOD AS A FUEL CAN BE HAZARDOUS.**



Industries 1994 LTD
PO Box 58652, Botany 2163, Auckland
www.warmington.co.nz

Due to continued product improvement, Warmington Ind LTD reserves the right to change product specifications without prior notification.