

Kiwi Grill Inbuilt Firebox

Installation of fire and flue System to comply with ASNZS 2918:2001

Due to continued product improvement, Warmington Ind LTD reserves the right to change product specification without prior notification.

Read all the instructions carefully before commencing the installation. Failure to follow these instructions may result in a fire hazard and void the warranty.

For specification see: www.warmington.co.nz

Copyright ©

Warmington Industries Ltd.			
PH: 09 273 9227 FAX: 09 273 9241 WEB: www.warmington.co.nz			
TITLE	Kiwi Grill Inbuilt Firebox		
DRAWN	Emlyn	DATE	25-09-18
SCALE	1/15	REVISION	02

SECTION B-B

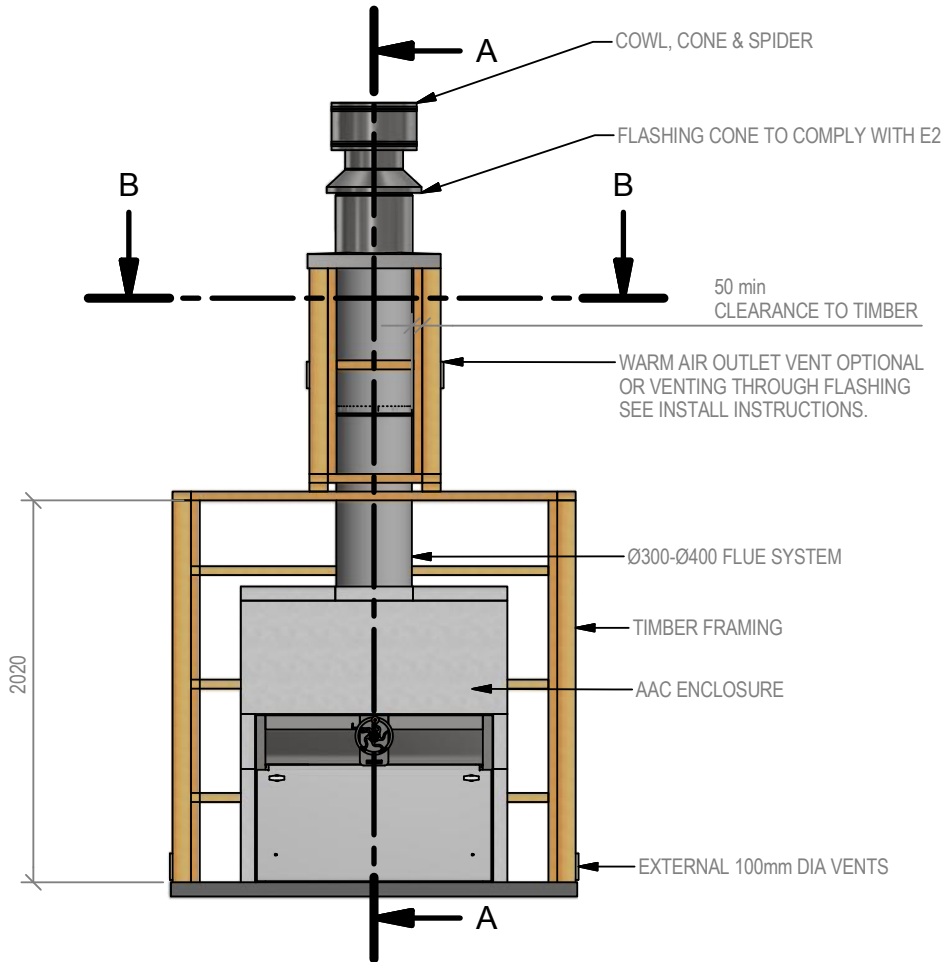
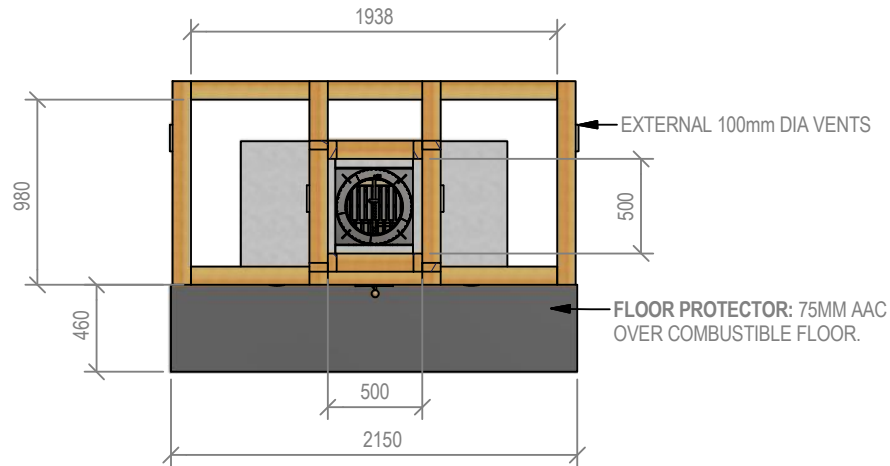

Kiwi Grill Inbuilt Firebox - Combustible Frameout Clearances (eg. Timber Framing)

Installation of fire and flue system to comply with AS/NZS 2918:2001

Due to continued product improvement, Warmington Ind LTD reserves the right to change product specification without prior notification.

Read all the instructions carefully before commencing the installation. Failure to follow these instructions may result in a fire hazard and void the warranty.

For specifications go to: www.warmington.co.nz

Copyright ©

Notes:

- Combustible frameout requires Autoclaved Aerated Concrete (AAC) enclosure
- Engineering calculations may be required for structural elements

SECTION A-A

FLUE OUTLET POSITION TO FULFILL
AS/NZS 2918 EXTERNAL REQUIREMENTS

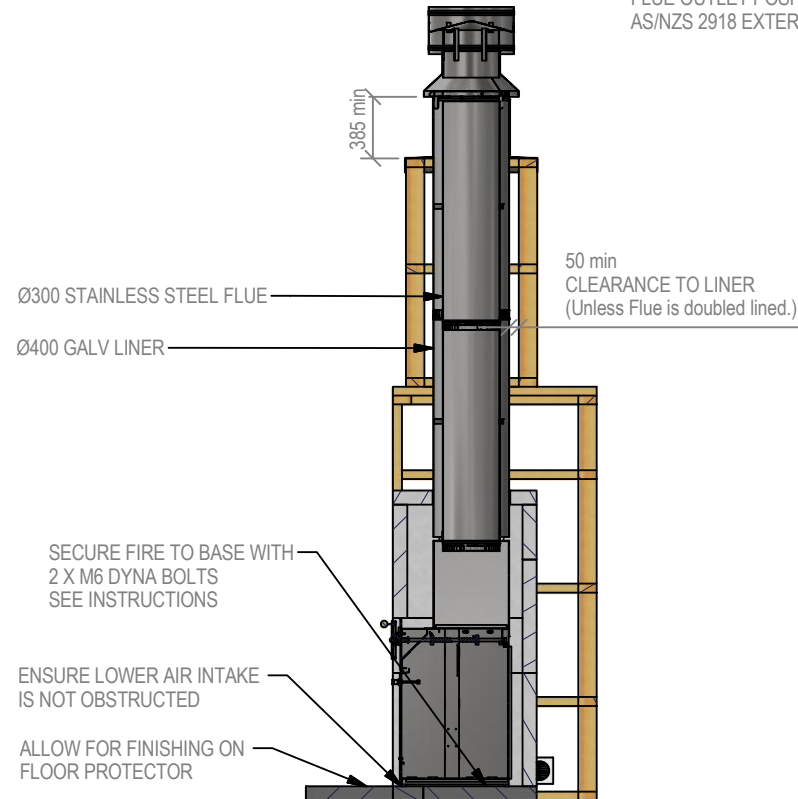

Warmington Industries Ltd.			
PH: 09 273 9227 FAX: 09 273 9241 WEB: www.warmington.co.nz			
TITLE	Kiwi Grill Inbuilt - Timber Framing		
DRAWN	Emlyn	DATE	25-09-18
SCALE	1/40	REVISION	02

SECTION B-B

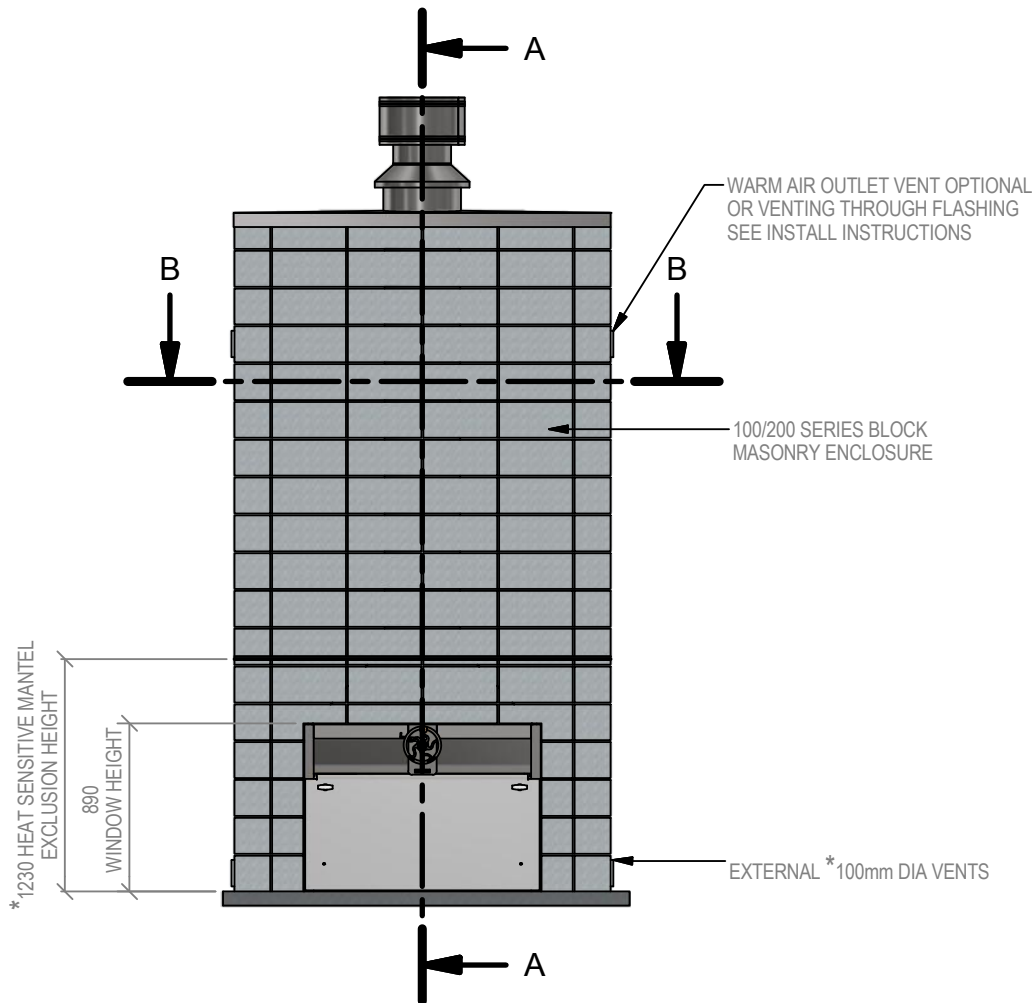
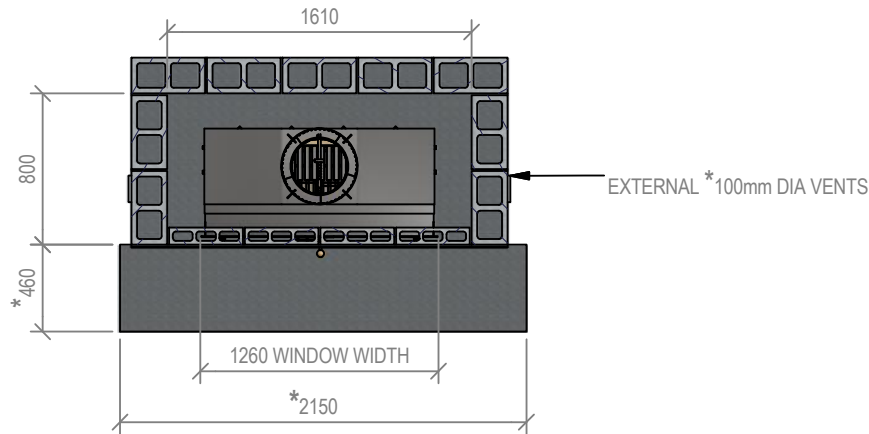

Kiwi Grill Inbuilt Firebox - Block Enclosure

Installation of fire and flue system to comply with AS/NZS 2918:2001

Due to continued product improvement, Warmington Ind LTD reserves the right to change product specification without prior notification.

Read all the instructions carefully before commencing the installation. Failure to follow these instructions may result in a fire hazard and void the warranty

For specification see: www.warmington.co.nz

Copyright ©

Notes:

- Block structure shown here is an example only (using standard series blocks).
- Critical minimum dimensions and details are *designated
- Engineering calculations may be required for structural elements

SECTION A-A

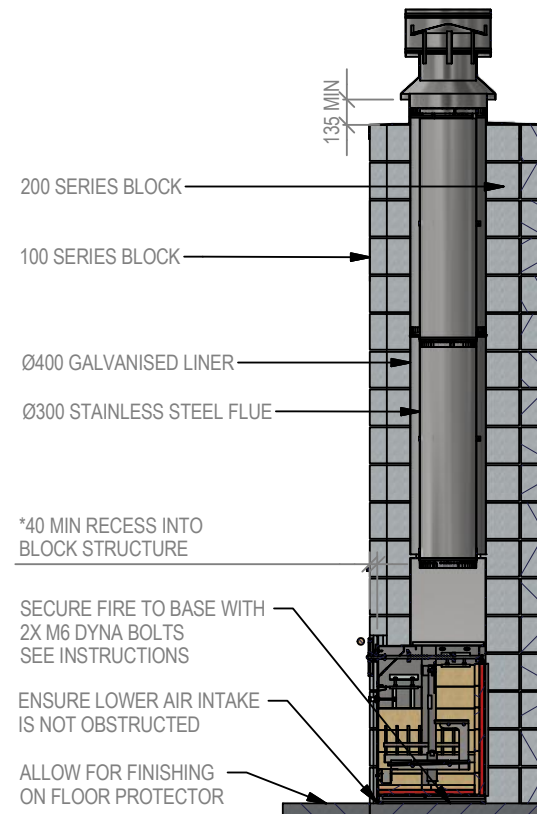

FLUE OUTLET POSITION TO FULFILL
AS/NZS 2918 EXTERNAL REQUIREMENTS

Warmington Industries Ltd.	
PH: 09 273 9227 FAX: 09 273 9241 WEB: www.warmington.co.nz	
TITLE Kiwi Grill Inbuilt - Block Enclosure	
DRAWN Emlyn	DATE 25/09/18
SCALE 1/40	REVISION 02