

Nouveau Taper Top Cabinets 900-1100-1250-1500

Outdoor Accessory for Warmington Nouveau Cooking Appliance Fires

Installation Instructions

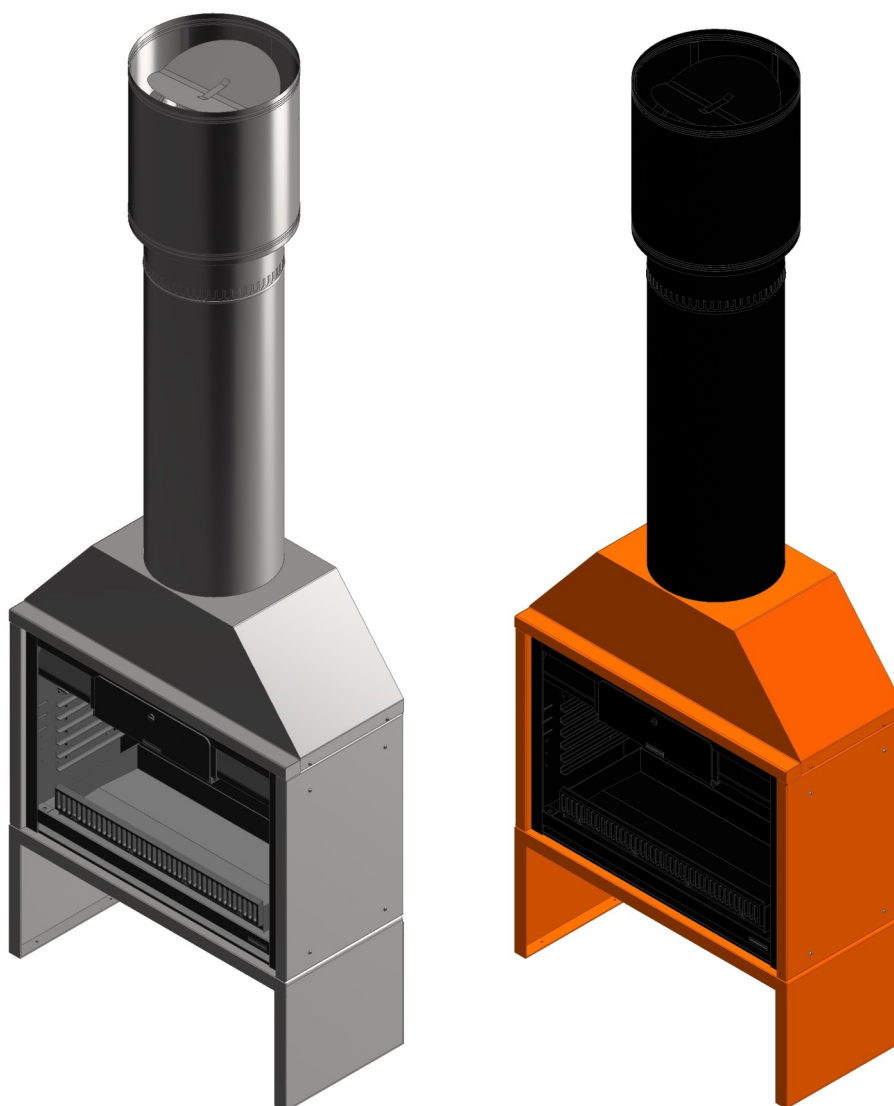

Note:

Base sold as an optional extra

Visit www.warmington.co.nz for specs, DWGs and PDF uploads of fires

Fire, flue system and instructions to comply with ASNZS 2918:2001 & Building Code C/AS1 7.5 Open Fires

Keep these instructions for further reference. Ensure that you have the correct and current installation details for the Warmington Fire.

IMPORTANT



Read all the instructions carefully before commencing the installation. Failure to follow these instructions may result in a fire hazard and void the warranty.

Due to continued product improvement, Warmington Ind LTD reserves the right to change product specifications without prior notification.

All dimensions are in mm

Copyright

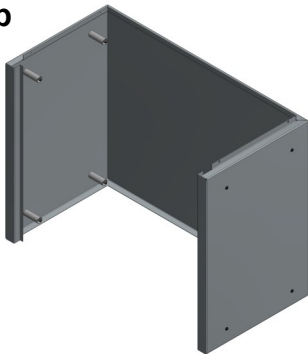
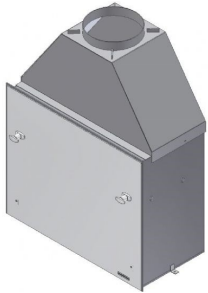
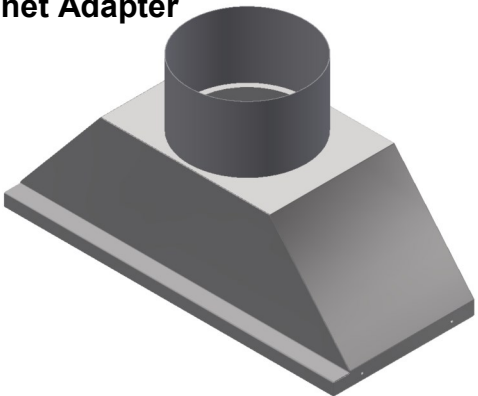
COMPONENTS FOR CONSTRUCTION

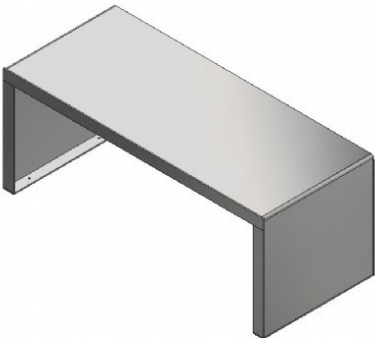
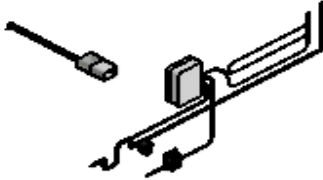
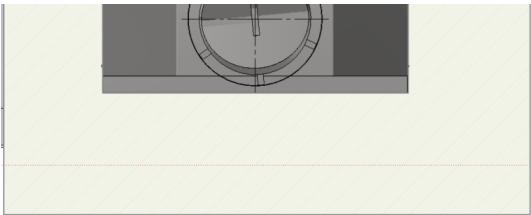
Supplied	No:	NOT Supplied (sold separately)	No:
Cabinet Wrap 	1	SN Firebox 	1
Cabinet Adapter 	1	Exhaust Sealant	
Cabinet Flue-kit 	1	Fire & Flue-kit Installation	
		Council Permit	
		NOT Supplied (Optional extra)	No:
		Cabinet Base 	1
		Log Lighter 	1
		Hearth 	1
		Gas & Electrical Work Onsite	

Due to continued product improvement, Warmington Ind LTD reserves the right to change product specifications without prior notification.

All dimensions are in mm

Copyright

GENERAL INFORMATION

The taper top cabinets are an accessory for Warmington's Nouveau outdoor fire series. They are designed to be installed with the relevant firebox in an outdoor area, either under cover or exposed to the elements. The purchase of a taper top cabinet is useful for minimising building costs on site, as no surrounding structure is necessary. The cabinet can either be purchased with a Warmington supplied base, in which case the appliance will be free-standing; or on it's own, in which case the firebox and cabinet surround shall be installed on a plinth type structure. Such design details should be discussed with a relevant builder, or contact your local Warmington retailer for more information.

POINTS TO CONSIDER PRIOR TO INSTALLATION

Location of the fire:

Open fires are better located at one end of a room or area, as they project the heat away from their opening.

The Topography of the Land:

The slope and position of the land in relation to the home has a bearing on how the wind will interact with the fire and flue system. Care needs to be taken to ensure that the flue termination is in the correct position to maximise performance.

The Prevailing Wind.

Care needs to be taken to ensure that the flue termination is in the correct position, as wind gusts that hit the flue and cowl system may overcome the cowl and draught back down the flue. This can be a combination of down draught and high pressure.

Wind Noise:

You may encounter wind noise in some installations. Enclosing the flue in a chase structure can reduce wind noise. However, there will always be some noise from the flue systems of fireplaces.

MATERIAL SELECTION

Two different material selections are available, with different applications for your outdoor space.

Stainless

If the cabinet is intended to be located in an area that is directly exposed to the weather, or if it is to be located near the coast, the stainless option is recommended. In this option, the cabinet is made of 304 grade stainless steel with a moderately reflective '2B' finish.

Corten

A further material option is specifying a cabinet out of COR-TEN steel (also known as architectural or weather resistant steel). This material is known for its unique rust like appearance, which can offer aesthetic appeal. Weathering action occurs by the formation of an initial surface corrosion layer (known as a patina). This layer protects the underlying material from further corrosion.

The patina on COR-TEN steel has a vibrant orange appearance. Weather resistance of this material is dependent on the initial formation of the patina. The material can be left to weather on its own, in which case the patina may be uneven or form rust runs. Alternatively, the material can be pre-rusted to form a more even patina. It is recommended to spray the material surface with a solution of 2 cups of hydrogen peroxide, 2 tablespoons of vinegar and half a teaspoon of table salt– twice a day for 5 consecutive days. Warmington does not supply this solution, but recommends its application to ensure the long term weather resistance of the material.

INSTALLATION

Important Notes:

- This is a general installation guide only. Contact a “NZHHA Installer” for installation advice or go to www.homeheat.co.nz, then select Members & follow instructions to find a certified NZHHA SFAIT installer.
- Install to AS/NZS 2918:2001.
- Install to manufacturer’s specifications.
- All new installations require a permit.

STAGE 1: PREPARATION

- Consider external dimensions of cabinet for positioning the appliance
- Consider relevant wall clearances and floor requirements. See page 5 of this document for details.

For cabinets to be installed under cover:

- Consider flue outlet. Flue position to be compliant with AS/NZS 2918:2001 section 4.9.
- Prepare ceiling/ roof penetration as required. All relevant penetrations to comply with AS/NZS 2918:2001 section 4.

1.1 WARMINGTON NOUVEAU FIREBOX DIMENSIONS

Description		SN 900	SN 1100	SN 1250	SN 1500
Firebox width	A	900	1100	1250	1500
Firebox height	B	760	760	910	910
Firebox depth	C	450	450	600	600
Flange width	D	950	1150	1300	1550
Flange height	E	785	785	935	935
Adaptor height	F	425	425	480	480

For more details on the firebox/ adaptor – see the Nouveau/ Nouveau Pizzeria firebox specifications on the Warmington website.

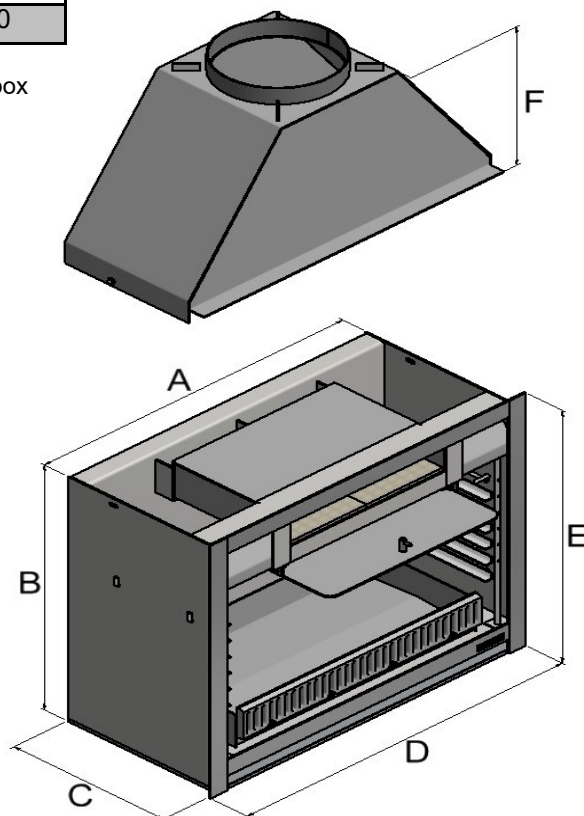

Due to continued product improvement, Warmington Ind LTD reserves the right to change product specifications without prior notification.

All dimensions are in mm

Copyright

1.2 EXTERNAL CABINET DIMENSIONS

Description		SN 900	SN 1100	SN 1250	SN 1500
Base/ cabinet width	G	1050	1250	1400	1650
Base height	H	500	500	500	500*
Base/ cabinet depth	I	535	535	685	685
Cabinet height	J	1213	1219	1407	1407
Flue diameter	K	300	350	350	450
Liner diameter	L	400	450	450	550
Freestanding flue system height	O	2210	2210	2210	2210

*For the Corten SN 1500 cabinet, the base height is 430mm.

Note:

Base sold as an optional extra

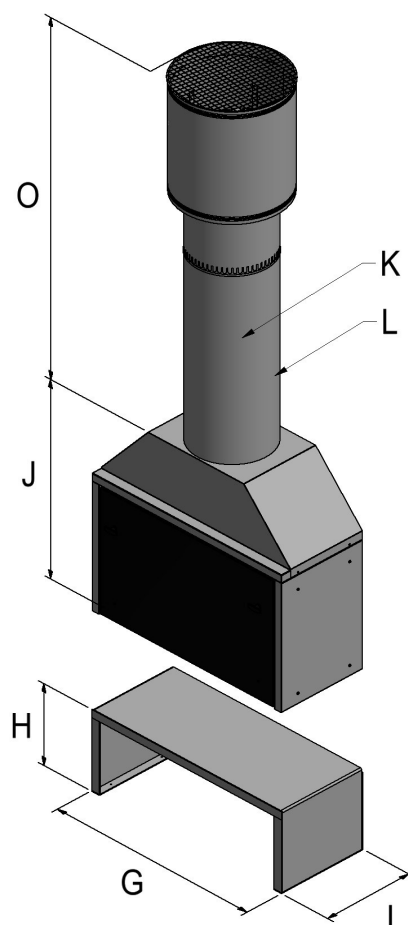

STAGE 2: BASE CONSTRUCTION (if specified)

- Drill into ground material for seismic restraint
- Position base in correct position and bolt to ground using (4x) M8 dyna bolts (not supplied)

Description		SN 900	SN 1100	SN 1250	SN 1500
Seismic restraint hole distance 1	M	335	335	485	485
Seismic restraint hole distance 2	N	1000	1200	1350	1600

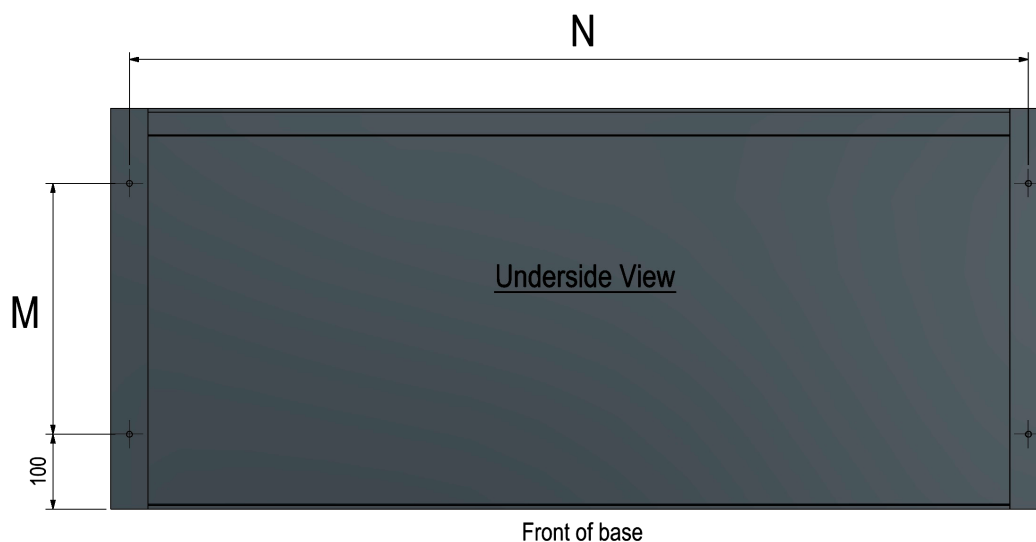

Due to continued product improvement, Warmington Ind LTD reserves the right to change product specifications without prior notification.

All dimensions are in mm

Copyright

STAGE 3: CABINET CONSTRUCTION

- Position firebox offset bars onto base (or plinth) according to drawing below.
- Lift firebox onto offset bars and screw each offset bar into sides of firebox using supplied M8 x 16 bolts.
- Drill and tap through interior firebox seismic restraints and bolt to base/ plinth using (2x) M8 bolts (not supplied) to secure firebox
- Install firebox adaptor if not already fitted to firebox (removing the adaptor before lifting the firebox may aid in ease of installation).
- Assemble cabinet sections. Models consist of three sections which screw together with supplied (6x) M8 x 16 cap screws. Washers and nuts supplied. Note: there are eight 73mm Spacer Studs which need to be screwed to the firebox. These offset the cabinet panels from the firebox (side to side).
- Fit cabinet panels around firebox and screw into firebox using supplied (8x) M8 x 12 bolts. If installing with the base, the sides and back of the cabinet should sit flush with the corresponding sides of the base.
- Install cabinet adaptor, bolt to cabinet panels using supplied (4x) M8 x 50 bolts.

Description		SN 900	SN 1100	SN 1250	SN 1500
Distance to front offset bars	O	32	32	32	32
Depth to back offset bars	P	432	432	582	582

Note: The front of the firebox flange is meant to sit recessed 27mm from the front of the base/ cabinet surround.

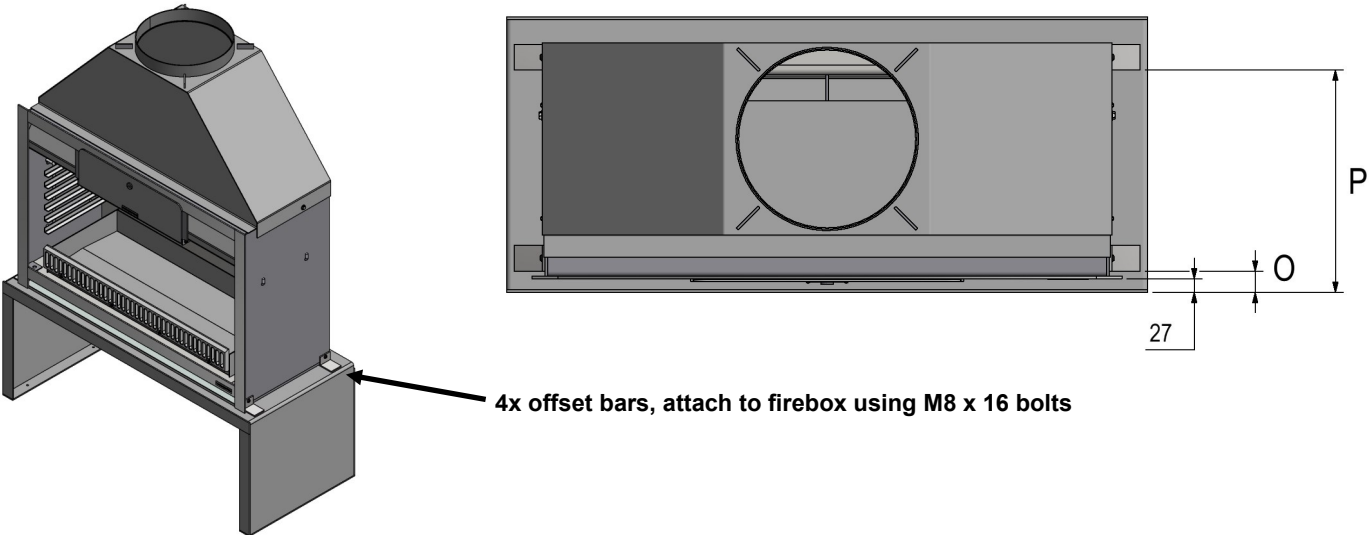

Note:
Base sold as an optional extra

Due to continued product improvement, Warmington Ind LTD reserves the right to change product specifications without prior notification.

All dimensions are in mm

Copyright

STAGE 4: FLUE SYSTEM INSTALLATION

- Drop first (1200mm) length of flue onto firebox spigot (flue sealing not required).
- Rivet 1200mm length liner to spigot on cabinet using monel rivets (not supplied).
- Install further flue/liner sections as required. Standard flue length is 1.5 sections. More required for roof penetrations. Final supplied liner length is cut down in order for installation of cowl system.
- Note: 1 spacer is supplied to go between the flue and liner, and should sit just below the top of the first length of flue. The spacer tightens to the flue. The liner is then riveted to the flanges on the spacer. More spacers may be required to be purchased for longer flue systems.
- Install outer cowl by riveting between final (600mm) length of flue and 6x spacers on cowl. Rivet through on the inside of the flue.
Note: There is a top spider supplied, the top of which should sit flush with the top of the flue.
- Drop down the inner butterfly cowl into the flue, such that it sits on the legs of the spider.
- Drop the top spigot/ bird proofing mesh down onto the cowl.

Note: the inner butterfly and top spigot/ bird proofing mesh do not need to be riveted in, such that the flue can be accessed for cleaning.

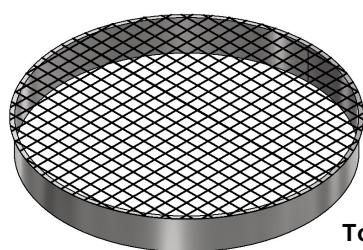

Top spigot/ bird proofing mesh

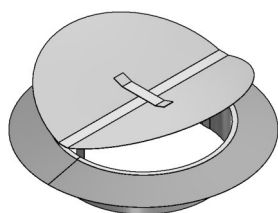

Inner butterfly cowl

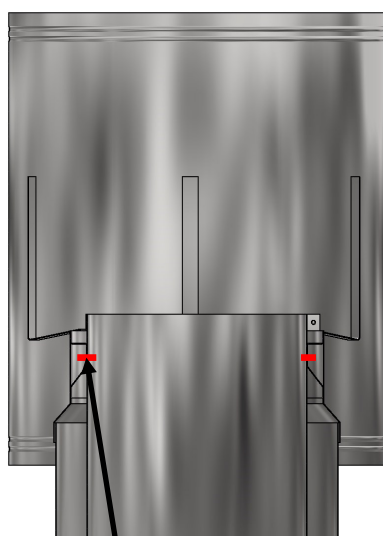

Rivet flue to cowl spacers from the

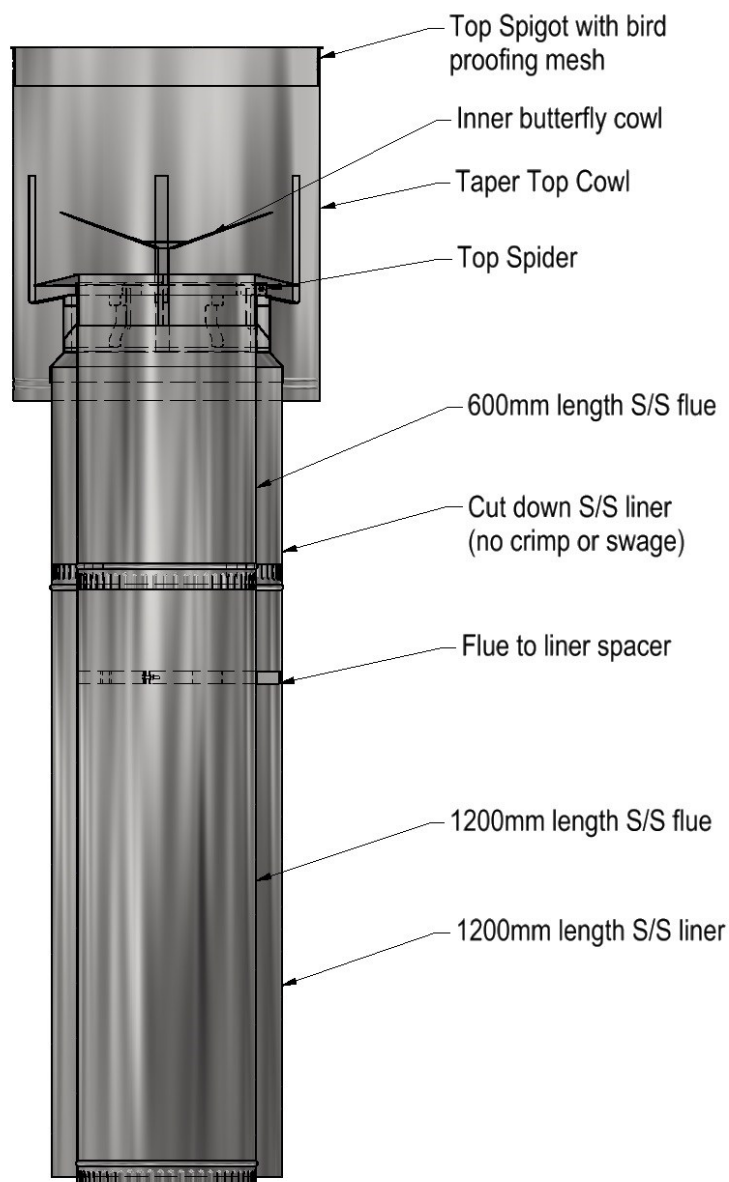

Note:

The above flue installation is for the freestanding flue kit, supplied with the cabinet as standard. If installing a more traditional flue system (ie one that is housed in a chase structure), follow the flue installation instructions in the Nouveau firebox specification document.

Due to continued product improvement, Warmington Ind LTD reserves the right to change product specifications without prior notification.

All dimensions are in mm

Copyright

ADDITIONAL INFORMATION

MINIMUM WALL CLEARANCES AND FLOOR REQUIREMENTS

The Nouveau fire/cabinet is an untested scenario. If installing with the base, Warmington requires the cabinet to be installed on a non-combustible floor and as per details below. Any deviation from this requirement must comply with AS/NZS 2918 section 3.3.

Furthermore, if installing on a plinth/ raised hearth situation, the appliance must comply with the requirements of AS/NZS section 3.3.3. Contact your local Warmington dealer or NZHHA certified installer for guidance.

Please Note:

Clearance values as shown are derived from the untested appliance section in AS/NZS:2918. In this situation, a single layer of continuous material (here the cabinet is taken as the heat shield element) spaced 25mm min) off any combustible material, has been implemented to give a clearance factor of 0.3, allowing the untested clearance to be reduced.

The clearances in the specification are measured from the outside of the cabinet, as this a more practical dimension for installers.

Description		SN 900	SN 1100	SN 1250	SN 1500
Cabinet front to flue centre	R	298	298	435	373
Minimum wall clearance– wall to cabinet side	S	285	285	285	285
Minimum wall clearance– wall to cabinet back	T	315	315	315	315
Hearth width projection	U	200	200	125	125
Hearth length projection	V	380	380	850	850

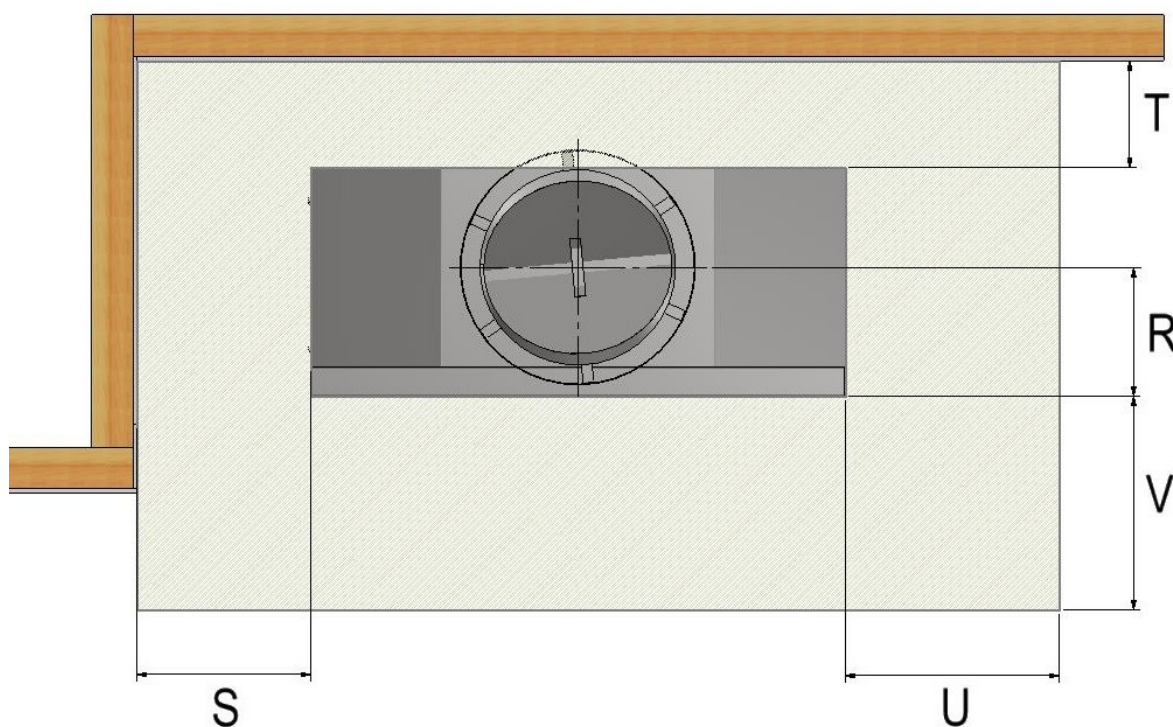

Due to continued product improvement, Warmington Ind LTD reserves the right to change product specifications without prior notification.

All dimensions are in mm

RETROFITTING GUIDE

If a cabinet is purchased separately from a corresponding firebox (eg. An existing firebox is on site and a cabinet is to be assembled around it), there is some remedial work involved to assemble the cabinet to the firebox.

- Drill and tap for M8 into the firebox to attach cabinet components. Follow drawing given below. Note: hole locations are taken from back of flange (for depth) and bottom of base frame (for height).

	Description		SN 900	SN 1100	SN 1250	SN 1500
Corten	Cabinet front bolting location depth	X1	78	78	78	78
	Cabinet back bolting location depth	X2	418	418	568	568
	Cabinet lower bolting location height	Y1	65	65	65	65
	Cabinet upper bolting location height	Y2	700	700	850	850
Stainless	Cabinet front bolting location depth	X1	78	78	78	78
	Cabinet back bolting location depth	X2	418	418	569	569
	Cabinet lower bolting location height	Y1	64	64	64	64
	Cabinet upper bolting location height	Y2	699	699	849	849

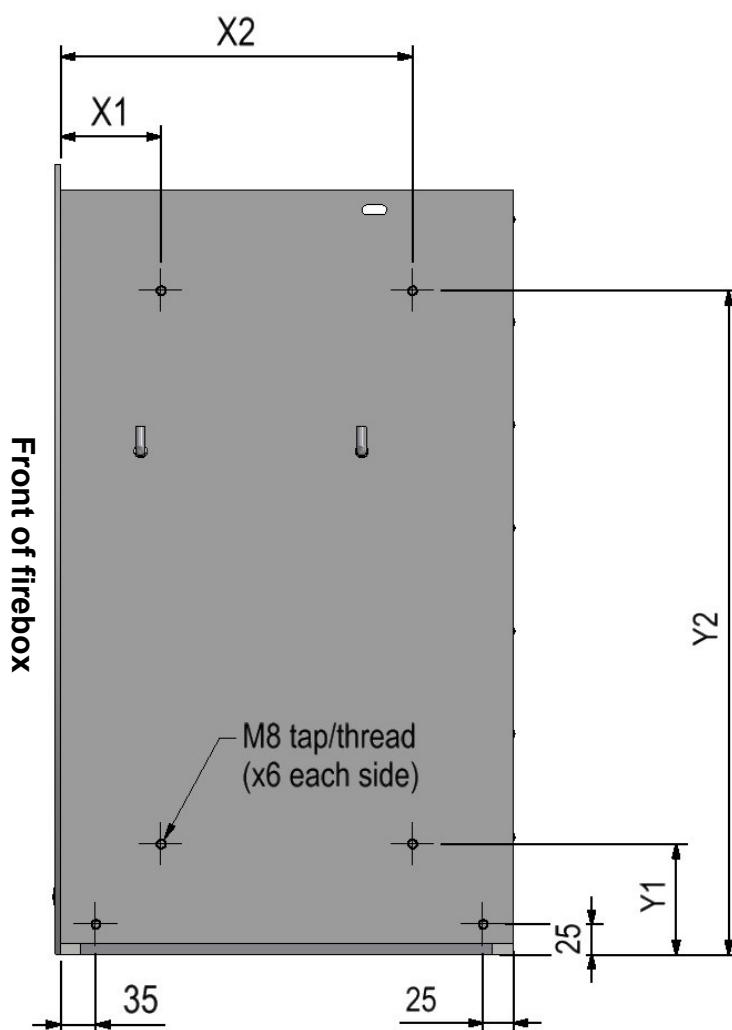
Note:

Hole locations on image are not to scale.

Due to continued product improvement, Warmington Ind LTD reserves the right to change product specifications without prior notification.

All dimensions are in mm

Copyright

GENERAL NOTES: ASNZS 2918:2001

NOTES:

- Warranty - for full details on product warranties, contact your local authorised Warmington retailer.
- Correct installation, operation and maintenance must be maintained to comply with Warmington warranty.
- The appliance and flue system must be installed in accordance with ASNZS2918:2001 and the appropriate building codes.
- The flue system and fireplace is to be swept annually or more frequently if required.

WARNINGS:

- **WARNING: THE APPLIANCE AND FLUE SYSTEM SHALL BE INSTALLED IN ACCORDANCE WITH AS/NZS 2918 AND THE APPROPRIATE REQUIREMENTS OF THE RELEVANT BUILDING CODE OR CODES**
- **WARNING: APPLIANCES INSTALLED IN ACCORDANCE WITH THIS STANDARD SHALL COMPLY WITH THE REQUIREMENTS OF AS/NZS 4013 WHERE REQUIRED BY THE REGULATORY AUTHORITY, I.E. THE APPLIANCE SHALL BE IDENTIFIABLE BY A COMPLIANCE PLATE WITH THE MARKING 'TESTED TO AS/NZS 4013'.**
- **ANY MODIFICATION OF THE APPLIANCE THAT HAS NOT BEEN APPROVED IN WRITING BY THE TESTING AUTHORITY IS CONSIDERED TO BE IN BREACH OF THE APPROVAL GRANTED FOR COMPLIANCE WITH AS/NZS 4013.**
- CAUTION: MIXING OF APPLIANCE OR FLUE-SYSTEM COMPONENTS FROM DIFFERENT SOURCES OR MODIFYING THE DIMENSIONAL SPECIFICATION OF COMPONENTS MAY RESULT IN HAZARDOUS CONDITIONS. WHERE SUCH ACTION IS CONSIDERED, THE MANUFACTURER SHOULD BE CONSULTED IN THE FIRST INSTANCE
- CAUTION: CRACKED AND BROKEN COMPONENTS MAY RENDER THE INSTALLATION UNSAFE.

Packing Check List	
Cabinet Adaptor	
Cabinet panels (x3)	
Offset bars (x4) + M8 x 16 bolts (x4)	
M8 x 12 bolts (x8)	
Spacer Studs (x8)	
M8 x 50 bolts (x4)	
Base (if specified)	
Flue system (if specified)	
• 1200mm length S/S flue	
• 1200mm length S/S liner	
• 600mm length S/S flue	
• Cut down S/S liner	
• 1x Spacer assembly (flue to liner)	
• 1x Top Spider	
• Taper top cowl	
• Inner butterfly cowl	
• Top spigot with bird proofing mesh	
Packed by:	

NOTE: For operation instructions download from www.warmington.co.nz



Industries 1994 LTD

PO Box 58652, Botany 2163, Auckland

Due to continued product improvement, Warmington Ind LTD reserves the right to change product specifications without prior notification.

All dimensions are in mm

Copyright