

SG to EG Burner Change Over

GAS OPEN FIRE SG to EG Burner Installation Guide Only

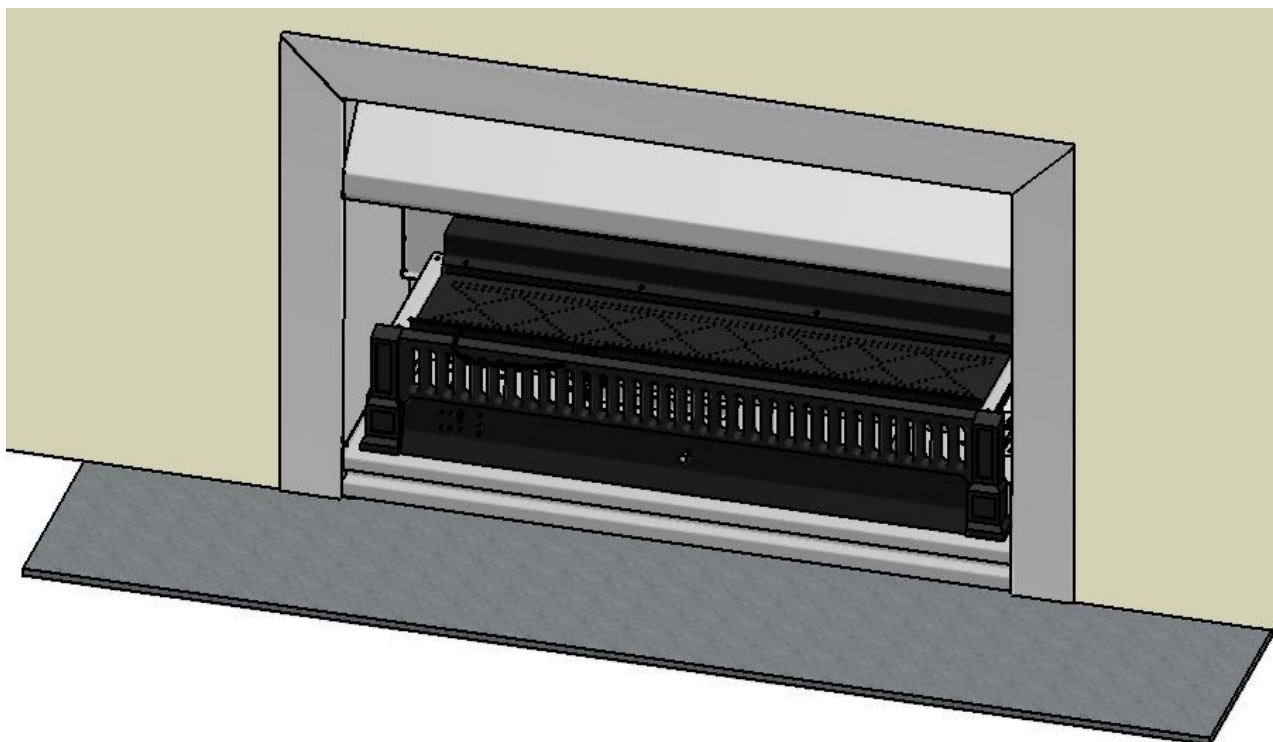

Related documents

Fire and flue system installation, and instructions to comply with NZS 5601.1:2013, 3645.1(Int):2010, 3645.2(Int):2010, 5266:2014, 2918:2001.

The fireplace is constructed and tested to comply with NZS 4558(int):2013 “Decorative gas log and other fuel effect appliances”.

Keep these instructions for further reference. Ensure that you have the correct and current installation details for the Warmington fireplace.

Installation

The Warmington unit is to be installed by a certified Warmington installer or an approved NZHHA installation technician.

See www.homeheat.co.nz/members for a certified NZHHA SFAIT Installer in your area.

A licenced certified gas fitter and licenced electrician are required to run power and gas supplies as required to the unit and any commissioning as part of the installation process. The heater must be installed according to these instructions and in compliance with all relevant building, gas fitting, electrical and other statutory regulations.

IMPORTANT

Read all the instructions carefully before commencing the Installation. Failure to follow these instructions may result in a fire hazard and void the warranty

CHANGING OVER A SG BURNER TO A EG BURNER

STEP 1: DISCONNECT & REMOVE SG BURNER FROM FIRE

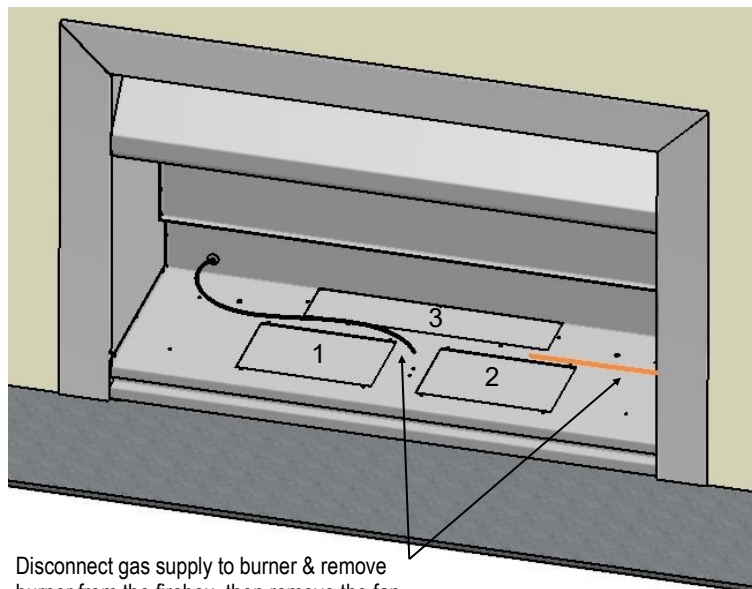

Disconnect gas supply to burner & remove burner from the firebox, then remove the fan assembly (if pre-installed), and feed 3 core power supply cable into firebox.

STEP 1a: Remove Existing SG Burner & Fan Assembly (if installed)

Ensure gas to the appliance is turned off, remove coals/ logs, Vermiculite & burner grate, then disconnect gas supply to the burner at the manual igniter control. Remove the SG burner from the firebox and feed a 3 core power wire through the left or right grommet hole at the back of the firebox. If a fan assembly was provided with the old firebox, remove the cover and the power supply for the fan will now become the power supply to the EG burner setup.

STEP 1b: Remove breakout panels

Remove the three breakout panels inside the firebox to accommodate the EG burner electronics supplied.

STEP 2: FIT 3 SPEED FAN ASSEMBLY & WIRING IN FIREBOX

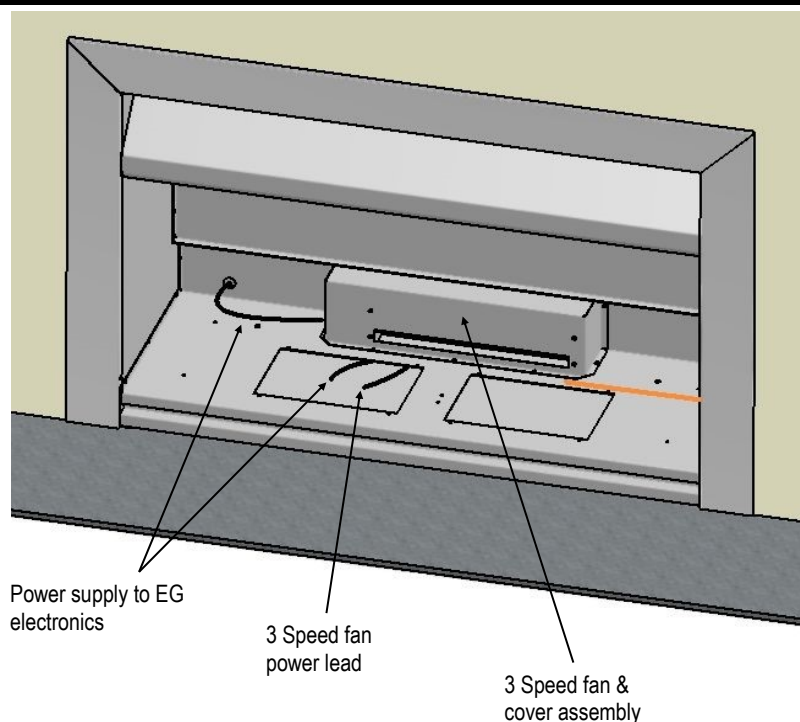

STEP 2: Fit 3 Speed Fan Assembly

Fit the fan in place using self tapping screws supplied & ensure to run the power supply cable & fan cable underneath the fan cover & under the breakout panels as shown above, this will help with connection into the circuit board in the next few steps. There is also a power lead supplied from the circuit board which should be joined to the power supply inside firebox, see next steps.

STEP 3: DISASSEMBLE PACKAGED ELECTRONICS & BURNER

STEP 3a: Disassemble packaged parts

Disassemble main burner assembly from RH side burner plate then remove the EG 845 control valve cover & EG main circuit board control cover. Take care to avoid any kinking of the copper pipework.

STEP 3b: Disassembled components ready for installation

The disassembled components ready for installation and should look as shown below. The main power supply should be joined with the main power supply 3 core loom (see wiring diagram on page 15), and fan wire will need to be connected to the main circuit board. All electrical & gas fitting work should be carried out by certified tradesman.

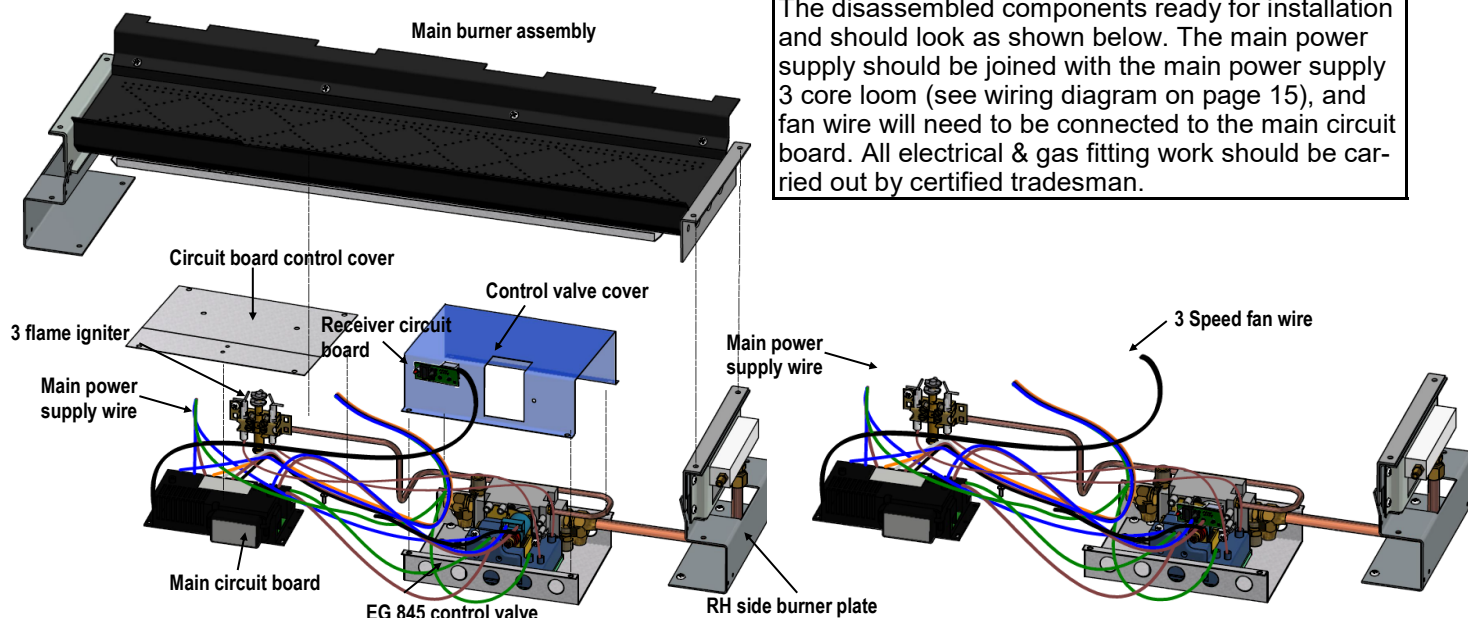

STEP 4: FIT EG COMPONENTS INTO THE FIREBOX

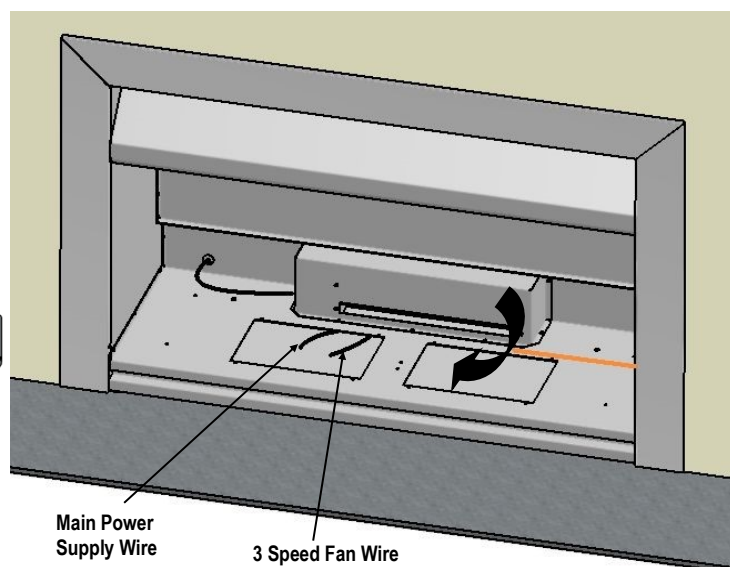
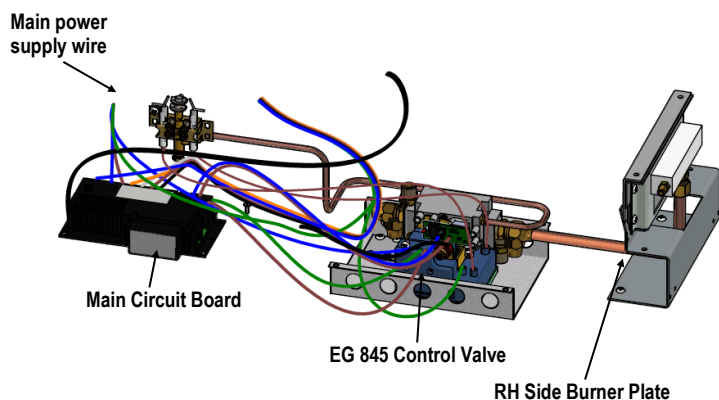

STEP 4: Fit EG components in position through RH side breakout panel

Fit previously disassembled components as shown above into firebox by feeding the main circuit board in first through the RH side breakout panel as indicated above followed by the EG 845 control valve assembly & RH side burner plate. Once in position inside the firebox ensure the main power supply wire & 3 speed fan wire are accessible to be connected. Once connected push the wires back under the breakout panel area to keep away from direct heat, also keep clear from the 3 speed fan area.

STEP 5: FIT EG COMPONENTS INTO FIREBOX

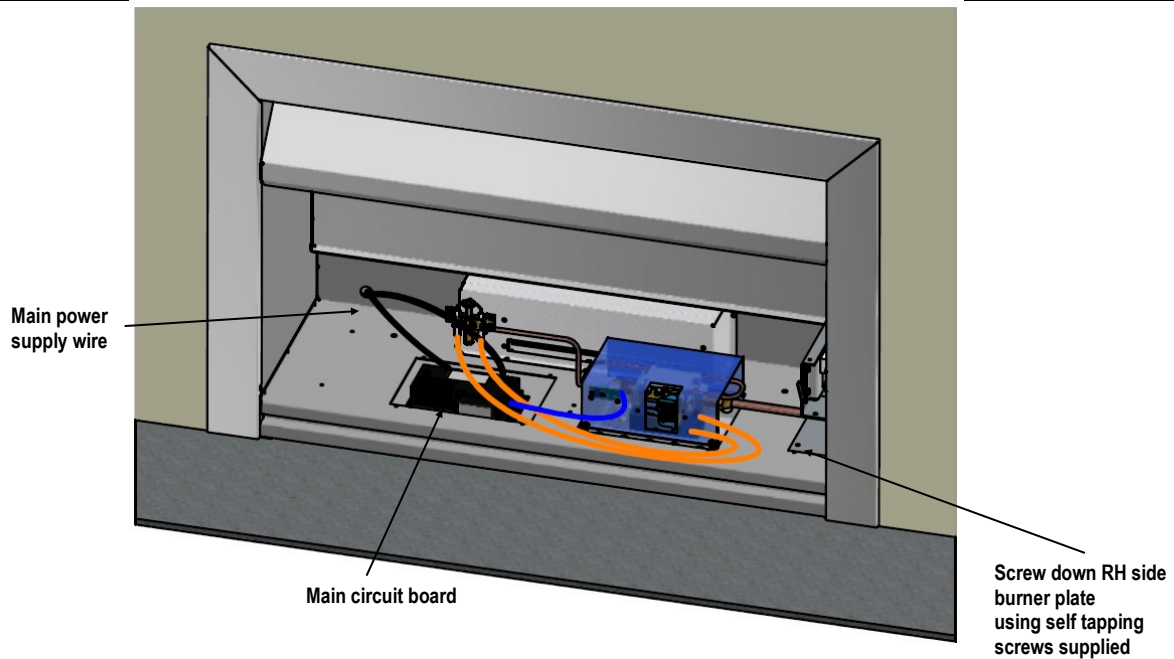

STEP 5: Fit EG components into firebox

Once EG assembly is fitted in place as shown above, screw RH side burner plate down using self tapping screws supplied. Do not screw down control valve & circuit board assembly until gas fitting & any electrical work has been carried out, both gas fitting & electrical work should be carried out at this stage. Feed the black CAT5 wire to the RH side where the control valve is located.

STEP 6: REASSEMBLE EG COMPONENTS COVERS & MAIN BURNER ASSEMBLY INTO FIREBOX

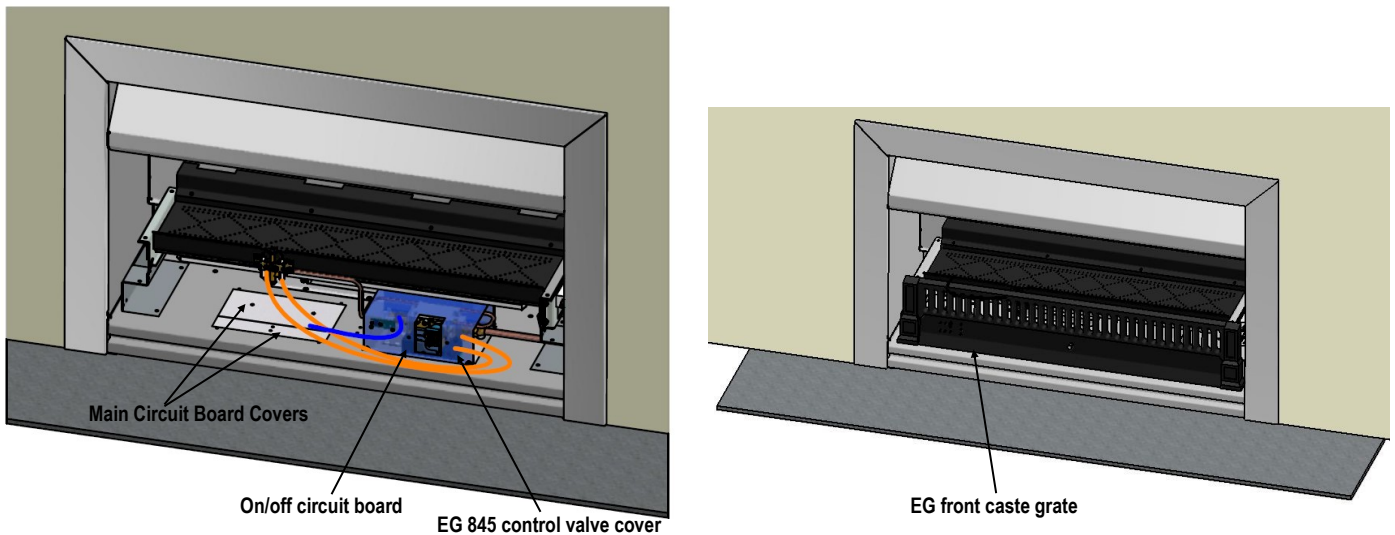

STEP 6 : Re-assemble Covers etc into Firebox

First screw down control valve cover & the 2 main circuit board covers in place as shown above, then fit the main burner assembly onto the RH burner side plate previously fitted in step 5 (take care to avoid damaging the gas injector jets on RH burner side plate). The EG 845 control valve cover has holes located for fitment of the receiver circuit board, this is glued onto the back to the cover with the Velcro strips provided. Once this is complete fit the burner grate to the main burner assembly with the locating pins on each side of the grate. For coal/logs setup, testing & commissioning see pages 5 to 15.

SG / EG Range: Gas Convection Fireplaces

TO THE INSTALLER / GAS FITTER and ELECTRICIAN

NOTES:

- Service annually or more if required.
- Custom built to clients requirements to relevant and current standards.
- The appliance and flue system must be installed in accordance with the relevant and current standards and the appropriate building codes.
- The appliance and flue system must be tested in accordance with the relevant and current standards and the appropriate building codes.

FLUED GAS APPLIANCES All gas fires requiring Warmington flue systems shall be Installed to the requirements of the current standards and shall be appropriately designed and constructed to permit safe and effective use. This Appliance must be flued to the outside atmosphere. All Warmington Fires must be Installed with a minimum of 3.6m of Approved **Warmington Gas Flue and Liners** .

GAS TYPE All Gas Fires shall operate safely on the Gas Type specified on the Appliance and shall comply with the requirements of The Gas Act 1992 .

APPLIANCE SAFETY Any gas fire appliance shall comply with the safety requirements of the current standards listed under "Related documents" in this specification.

ELECTRICAL REQUIREMENTS All gas fire appliances installed with mains supplied electrical components for associated use with these appliances, must comply with the current Electricity Act.

ELECTRONIC CONTROL SYSTEMS Any gas fire appliance Installed with Manual or Programmable Electronic Control System shall be tested and/or approved by a Recognised Person or Authority.

SEISMIC RESTRAINTS All Fires used for Domestic and Commercial Purposes shall be firmly secured (unless defined as portable or mobile) to prevent dislodgement from their point of fixture or Installation during Seismic Activity. Such Restraint must be of a reasonable expectation .

GAS CONNECTION A Gas Certificate must be obtained for the Installation and Commissioning of this Appliance and Flue System.

Check that the Gas Type Specified on the Data Plate is correct for the available supply (LPG or NG).

A Copper Gas supply capable of supplying the correct MJ/h , should be brought into the rear of the Installation Cavity through the hole provided . A Flare Nut is provided on the Burner for Gas Connection to the Appliance .

COMMISSIONING AND TESTING OF FIREPLACE

(To be carried out by Gasfitter)

Read all the instructions before commissioning. Install coals and logs and burner before commission.

Light appliance and check HIGH/LOW settings. Check operation of appliance and adjust to suit.

Adjust control valve setting if required. After a period of running (30min Plus) check the setting of the pilot and adjust if required. See Spec's for details.

Extinguish appliance, remove test equipment and secure test nipple. Check for Gas Leaks.

Note* The Control Valves are factory set and should not require adjustment.

GAS FITTER TO CARRY OUT STANDARD TESTING FOR COMMISSION:

- Spill test taken at top of opening with smoke or smoke match.
- Leak testing appliance and joints.
- Correct operation of the burner and coal and log lay out.
- Test gas pressures high and low, drop test on supply line.
- 5 second light time across burner. Other testing that may be required.
- Ventilation requirements to the standards.
- Clean and or touch up paint of fire box and burner
- Hand over to client. tests and comply to relevant standards.

FITMENT OF BURNER

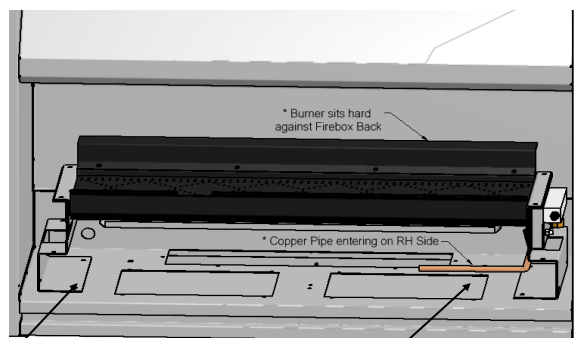

Burner may be Secured To the Firebox (Optional)

Gas Supply Pipe Into Fire , by Gasfitter . See Spec's for Pipe Size.

VERMICULITE (COARSE) - to be set by Gasfitter

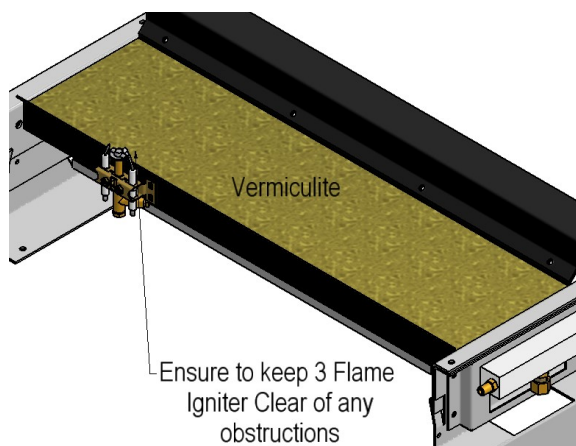

General Coal orientation for optimum effect.

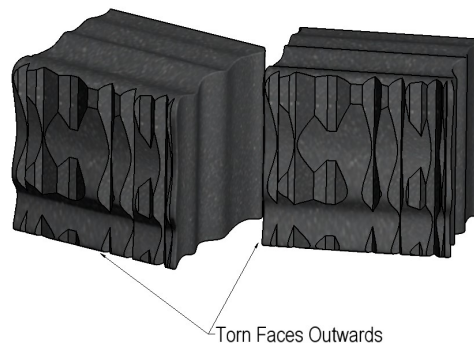

APPLYING THE VERMICULITE: (coarse - must be larger than the burner plates holes so not to block them)

Apply with care a thin layer of Vermiculite over the Burner, just enough to cover the Burner Tray only .

NOTE: If the burner flame is uneven, the Vermiculite may need to be changed or sifted to remove the smaller pieces that can block the burners holes. The smaller pieces can cause uneven burn and the unit to run dirty.

COALS AND LOGS - to be set by Gasfitter

Gloves should be worn when handling ceramic fibre Coals & Logs: as the carbon on the coals can stain the surroundings.

HELPFUL HINT: When use metal tongs when hot.

Apply a thin layer of Vermiculite over the burner, just enough to cover the burner tray only, as shown above.

1: Bottom Row: Assemble 2 Bottom Rows of coals onto the Vermiculite Base. **2: Top Row:** Assemble 2 top rows of coals onto the bottom row.

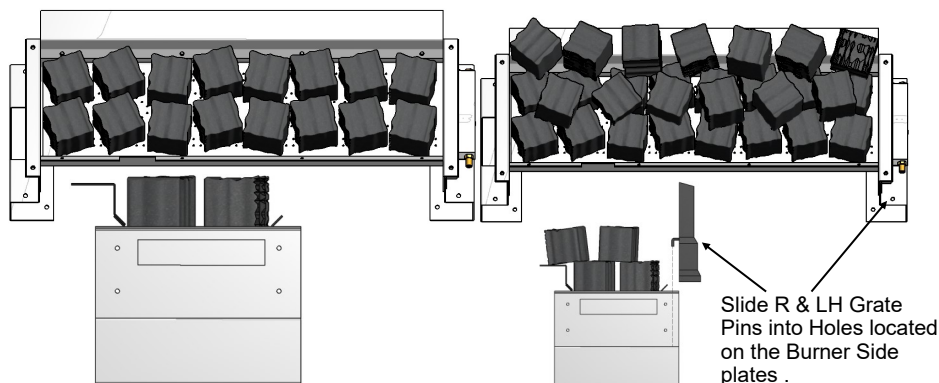

1: bottom row

2: top row

Each coal randomly positioned with the torn (rough) facing outward. **Ensure coal positioning does not directly block the 3 Flame Pilot .**

Model SG780 Shown: Total number of coals will vary per model.

The placement of the coals & logs may vary to make an even flame pattern.

Logs and twigs may be scattered to achieve best visual effect .

	Number of Coals per Row		Number of Rows		Total Coals
Model	Bottom	Top	Bottom	Top	Total
SG / EG 600	5	4	2	2	18
SG / EG 700	6	5	2	2	22
SG / EG 780	8	6	2	2	28
SG / EG 900	10	9	2	2	38
SG / EG 1100	11	10	2	2	42

FASCIA KIT - Black or Stainless Steel

- Locate the three self-tapping screws provided into the under-side of the top ledge of the firebox
- Remove the backing tape from the adhesive Velcro pads at the bottom of each fascia side
- Offer the fascia into position locating the three screws into their associated slots - tighten screws
- Apply firm pressure to the bottom edges to bond the Velcro tape
- The fascia may be removed at any time by loosening the screws and parting the Velcro
- **Please refer to additional sheet for Burner Ratings and Frame-out details.**

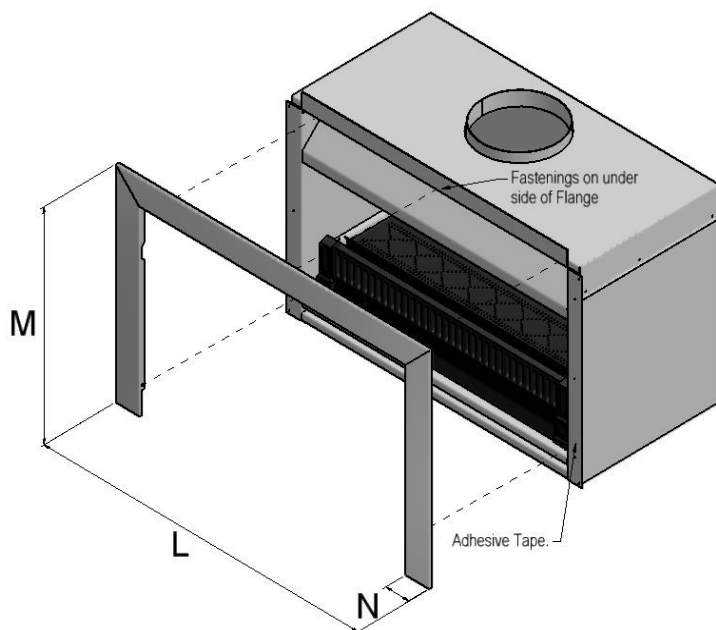

Note:

Fascia is fitted at the end of the installation process and may be after the wall and surroundings have been completed.

ADJUSTMENT OF THE PILOT - 3 FLAME for BOTH SG & EG

Adjusted by Gasfitter ONLY

Note: When the base screw is removed, gas will leak from the out let, ensure that the pilot is not adjusted or the screw is removed when the fire is burning.

- Adjustment of Pilot - 3 Flame: Unscrew base screw as shown in Diagram 2.
- Insert a screwdriver as shown in Diagram 3 and adjust the adjustment screw up inside the 3 Flame Pilot to adjust the flame height.
- The flame must always be passing over the Electrodes &/or File Tube on either side.
- Replace the Base screw and check for leaks.

Note: to Gasfitters

The 3 flame pilot may need adjustment after a period of running time on set up as the increase in heat in the fire will induce a higher draft in the fire, and may pull in flame away from the File Tube causing the fire to shut down.

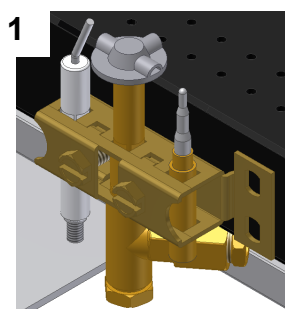

3 Flame Pilot in assembled state

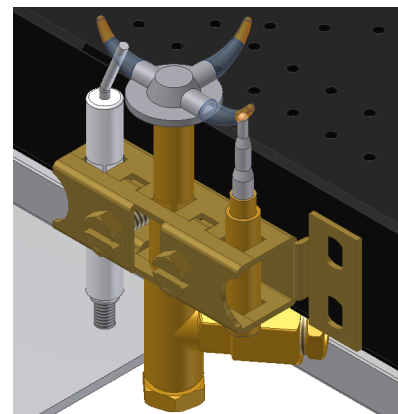
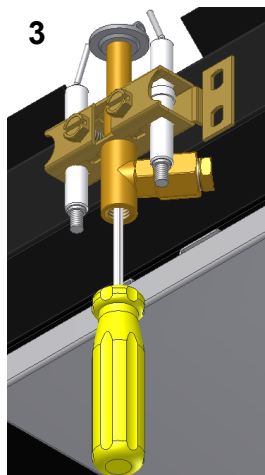
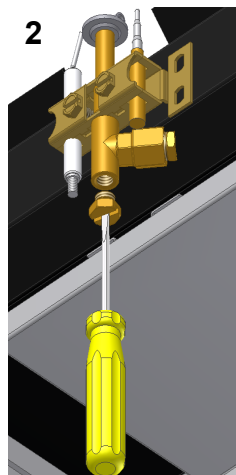

Correct operation of 3 Flame Pilot

POINTS OF SAFETY - To the Customer /Home-Owner

Your Warmington Gas decorative fire operates on the principle of dual radiant and convected heat. Therefore it is important to observe the following precautions associated with any heating appliance or open fire.

- Do not cover or restrict the fireplace upper or lower vents in any way as this may result in a build-up of hazardous gases within the room.
- The fire is not intended for the drying of clothing, bedding etc.
- Avoid installing this appliance in high traffic areas, strong draughts or near drapes or furniture.
- The use of an approved fireguard is recommended for the protection of young children.
- Avoid using aerosols when the appliance is operating.
- Avoid anyone leaning against or lying directly in front of the fire while operating.
- Do not place anything objects into or against the gas fire at any stage.
- The fire may release a small amount of smoke on its first start up which may take 1or 2 hours to dissipate . This is part of the curing process so ensure there is adequate ventilation within the room.
- Always use a registered Gas Fitter or Electrician for installing and maintenance work
- Always use certified gas cylinders that have been tested and are safe to use.
- Never modify your gas appliance or its settings from those specified by the manufacturer.

APPLIANCE SAFETY Any gas fire appliance shall comply with the safety requirements of the current standards listed under "Related documents" in this specification.

ELECTRONIC CONTROL SYSTEMS Any gas fire appliance fitted with manual or programmable electronic control systems shall be tested and/or approved by a recognised person or authority.

SEISMIC RESTRAINTS All gas fires used for domestic and commercial purposes shall be firmly secured (unless defined as portable or mobile) to prevent dislodgement from their point of fixture or installation during seismic activity.

WHAT DO YOU DO IF YOU SMELL GAS

- Open windows and doors
- Do not light any gas appliance
- Do not use any electrical appliance or switches
- Do not use the telephone in your home
- Leave the building; shut off the domestic gas supply valve (beside your meter)
- Call your gas supplier/gasfitter or the Fire Service for further advice.

MAINTENANCE: All burner settings, coal placement and vermiculite is to be checked and set in accordance with this specification by the Service person/Gasfitter

Lighting your gas fire using electronic or remote ignition systems may vary as per manufacturer instructions

Warmington Industries recommend annual servicing of your gas fire by an approved Warmington dealer Gasfitter.

External surfaces should be dusted with a damp, lint-free cloth when the fire is cold.

Warmington Industries provide 12 months warranty from the date of purchase, for domestic or commercial installations

The Warranty Covers:

- Replacement Parts and Labour for Gas Control Components due to Manufacturing Defects Only.
- Repair or Replacement of the Burner or Firebox Components due to Manufacturing Defects Only.
- Warranty cover will be considered void if the product is subject to incorrect installation, failure to operate the appliance in accordance with the supplied instructions and specifications or is subject to damage or misuse beyond the expected conditions of normal use.
- All installations and servicing must be carried out by and approved Warmington dealer or Gasfitter.

OPERATION OF YOUR REMOTE CONTROLLED EG GAS BURNER (SIT 845 valve)

REMOTE CONTROL FEATURES

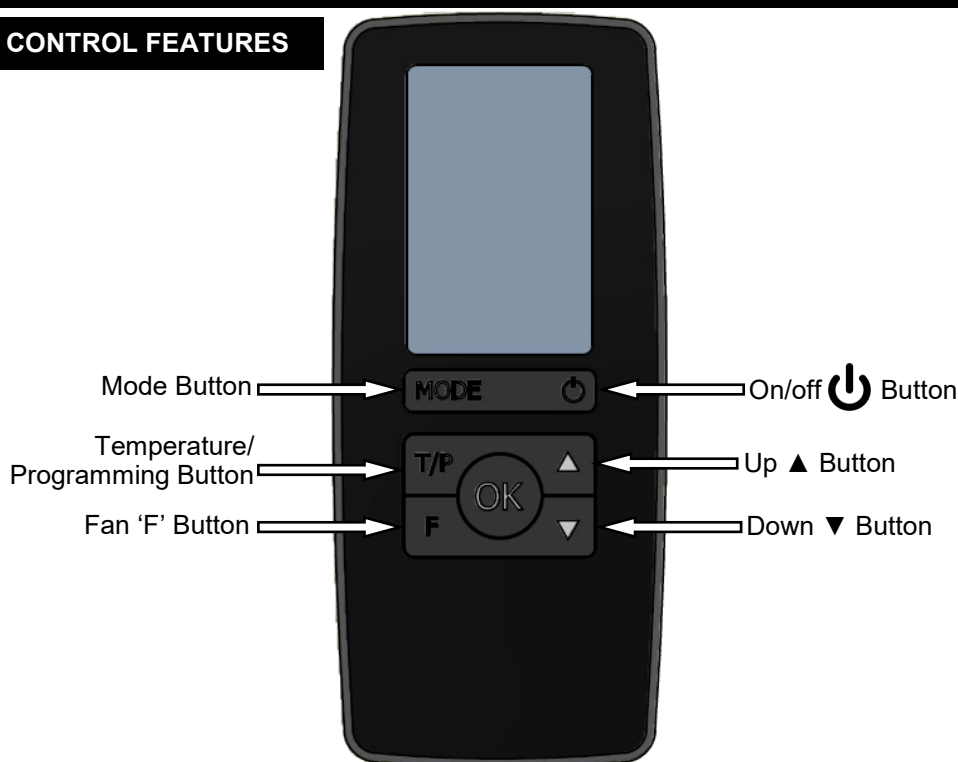

Press and release the  button to turn the remote on and off.

SETTING THE DAY OF THE WEEK AND TIME

With the remote off, press and hold the 'T/P' button for 2 seconds or longer to initiate programming the time. The Time, Hour setting and AM/PM will flash.

Setting the hour function: Press and release the ▲ or ▼ button to increase or decrease the hour setting by 1 hour. Please ensure that AM/PM is set correctly. Press 'OK' to accept. The minute digits will begin to flash.

Setting the minute function: Press and release, the ▲ or ▼ button to increase or decrease the minute setting by 1 minute. Press and hold the ▲ or ▼ button for 2 seconds or longer to increase or decrease the minute setting by 1 minute every 0.5 seconds. Press 'OK' to accept. The days of the week will begin to flash.

Setting the day of the week function: Press and release the ▲ or ▼ button to change the day of the week to the following or previous day. Press and hold the ▲ or ▼ button for 2 seconds or longer to increase or decrease the day of the week by 1 day every 0.5 seconds. Press 'OK' to complete setting. The time and day of the week is now set.

USING THE VARIOUS MODES

While the remote is switched on, pressing and releasing the MODE button will cycle between all available modes. These are:

Manual Mode→Auto Mode→Flame Mode→Manual Mode

Manual mode

Manual mode does not require that the time and day of the week to be set. Press the ▲ or ▼ button to increase or decrease the temperature as desired. The Fan speed can be adjusted at any time by pressing the 'F' button. Pressing and releasing the 'F' button will cycle through fan speeds of 1, 2, 3 Off and back to 1.

Automatic mode

The automatic mode allows the temperature to be regulated according to a programmed level and time. At any time, the temperature may be adjusted up or down. However, whenever the remote changes to a new time period, the temperature will be set automatically according to that period's setting. The Fan speed can be adjusted at any time by pressing the 'F' button. Pressing and releasing the 'F' button will cycle through fan speeds of 1, 2, 3 Off and back to 1. Note, that the fan speed will not change automatically, but remain at the last selected speed.

Flame Mode

In Flame mode the flame level is selected as required, and remains at the selected level. A change in the temperature will not change the flame level. Press the ▲ or ▼ button to increase or decrease the Flame level desired. The Fan speed can be adjusted at any time by pressing the 'F' button. Pressing and releasing the 'F' button will cycle through fan speeds of 1, 2, 3, Off and back to 1.

Programming for Auto Mode

Each day of the week can be programmed individually for 4 periods P1, P2, P3 and P4, making a total of 28 programmed periods. Alternatively, a weekday program can be set, so the same program is used for Monday-Friday. Similarly, a weekend program can be set for Saturday-Sunday. The entire week can also have the same program. Alternatively, a weekday or weekend program can be set with individual programs for the remaining days.

The suggested period settings for each day/s are:

Period 1 - morning

Period 2 - daytime

Period 3 - evening

Period 4 - night-time

Entering programming mode:

With the remote off, Press and hold the 'T/P' button for 2 seconds or longer then release, followed by another press and release of the 'T/P' button. If successful, the LCD will display 'Pd' at the top, and the word PROG at the bottom. The time at which the remote is currently set, and MO will flash.

Select which day/s to program. You must choose which day/s of the week you wish to program. Press and release the ▲ or ▼ button to change the day of the week to the following or previous day. Press and hold the ▲ or ▼ button for 2 seconds or longer to increase or decrease the day of the week by 1 day every 0.5 seconds. The order that you can scroll through the days is as follows:

MO→TU→WE→TH→FR→ 'MO TU WE TH FR' → SA → SU → 'SU SA' → 'MO TU WE TH FR SA SU'

To accept the selected day/s of the week press 'OK'.

First period's start time. The display will indicate 'P1' on the top. The Hour and AM/PM settings will now flash.

To set the P1 starting time:

Press and release the ▲ or ▼ button to increase or decrease the hour setting. Press and hold the ▲ or ▼ button for 2 seconds or longer to increase or decrease the hour setting by 1 hour every 0.5 seconds. Please ensure that AM/PM is set correctly. Press 'OK' to accept. The Minute setting will now flash.

Adjust the minute setting:

Press and release the ▲ or ▼ buttons to increase or decrease the minute setting. Press 'OK' to accept. Setting the temperature. The Set Temperature setting will now flash.

Adjust the desired set temperature:

Press and release the ▲ or ▼ button to increase or decrease the temperature setting by 1 °C. Press and hold the ▲ or ▼ button for 2 seconds or longer to increase or decrease the temperature setting by 1°C every 0.5 seconds. Press 'OK' to accept. Period 1 is now set for the day/s of the week that you have chosen. The LCD will display 'P2' to indicate that Period 2 can now be set for the same day/s of the week. Repeat the programming process for periods 2, 3 and 4. After program 4 is set, press 'OK' and the program for the selected day/s will be set. Repeat the programming process for any other periods/days that are required.

Restore factory default settings

With the remote off, press the following sequence of buttons: 'F', 'T/P', 'T/P' again, ▼. If done correctly, the icon 'rE' will be indicated on the LCD.

Teaching RF remote ID code to control unit

CAUTION: The remote has already been programmed with a unique code. Do not attempt to teach the RF Remote ID code unless instructed by the manufacturer. With the remote off, press the following sequence of buttons: 'F', 'T/P', 'T/P' again, ▲. The LCD display will show 'LC' (Learn Code) for 2 seconds then return to the normal OFF state display. During this time a special code will be transmitted by the RF Remote to the Control Unit, causing the Control Unit to learn its ID.

APP OPERATION

The app can be used both on iOS and Android devices they can be downloaded here:

Apple Store: <https://apps.apple.com/jm/app/intelligy-thermostat-mkii/id1327577138>

Google Play Store: <https://play.google.com/store/apps/details?id=com.millec.intelligythermostatmkii>

Or search for “Intelligy Thermostat MKII” in your smart phone app store

For instructions on how to push the appliance to your Wi-Fi, please go to the Warmington website and find details located under the ‘Downloads’ tab for your fireplace model.

The app has both manual control and automatic controls.

In manual control you can adjust the flame height by touching the < and > symbols next to the flame icon.

In automatic control you can adjust the desired room temperature by touching the < and > symbols next to the temperature.

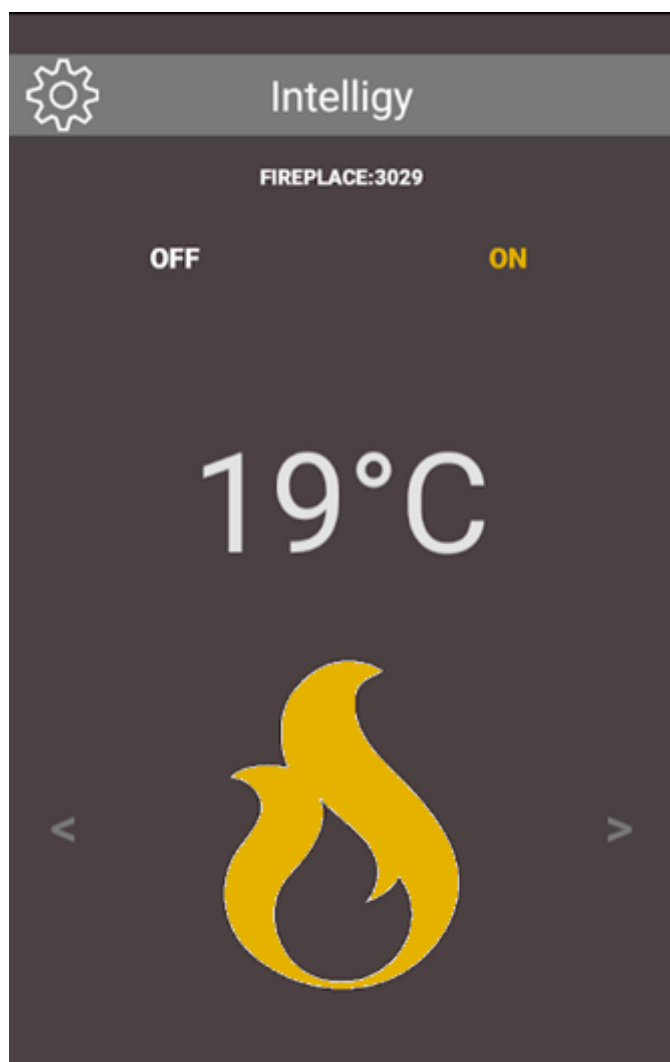

Manual

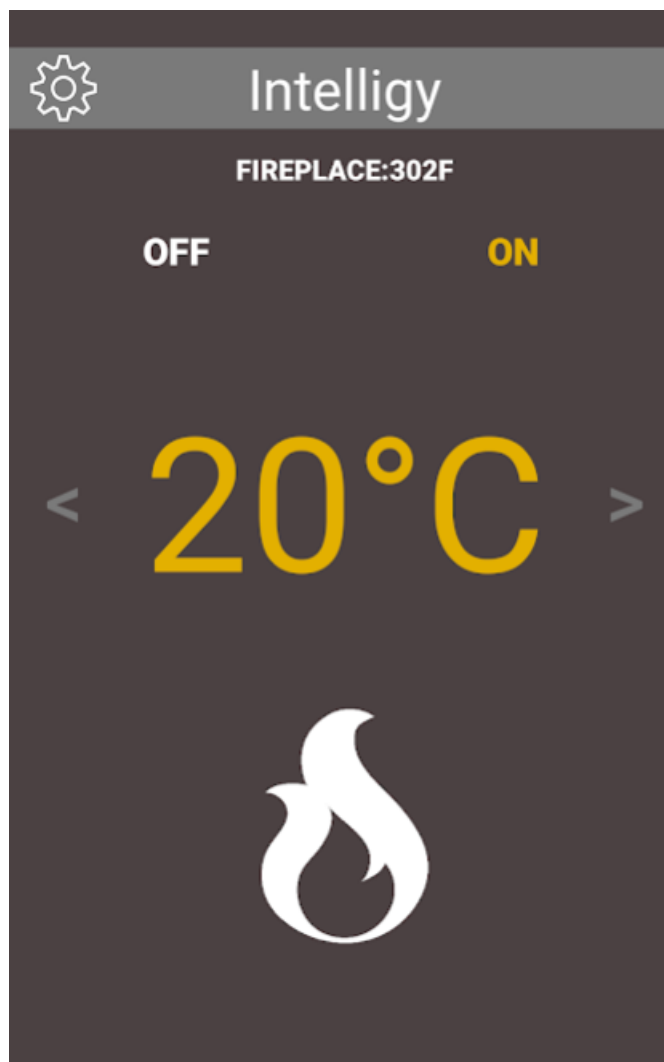

Automatic

MANUAL ON/OFF SWITCH

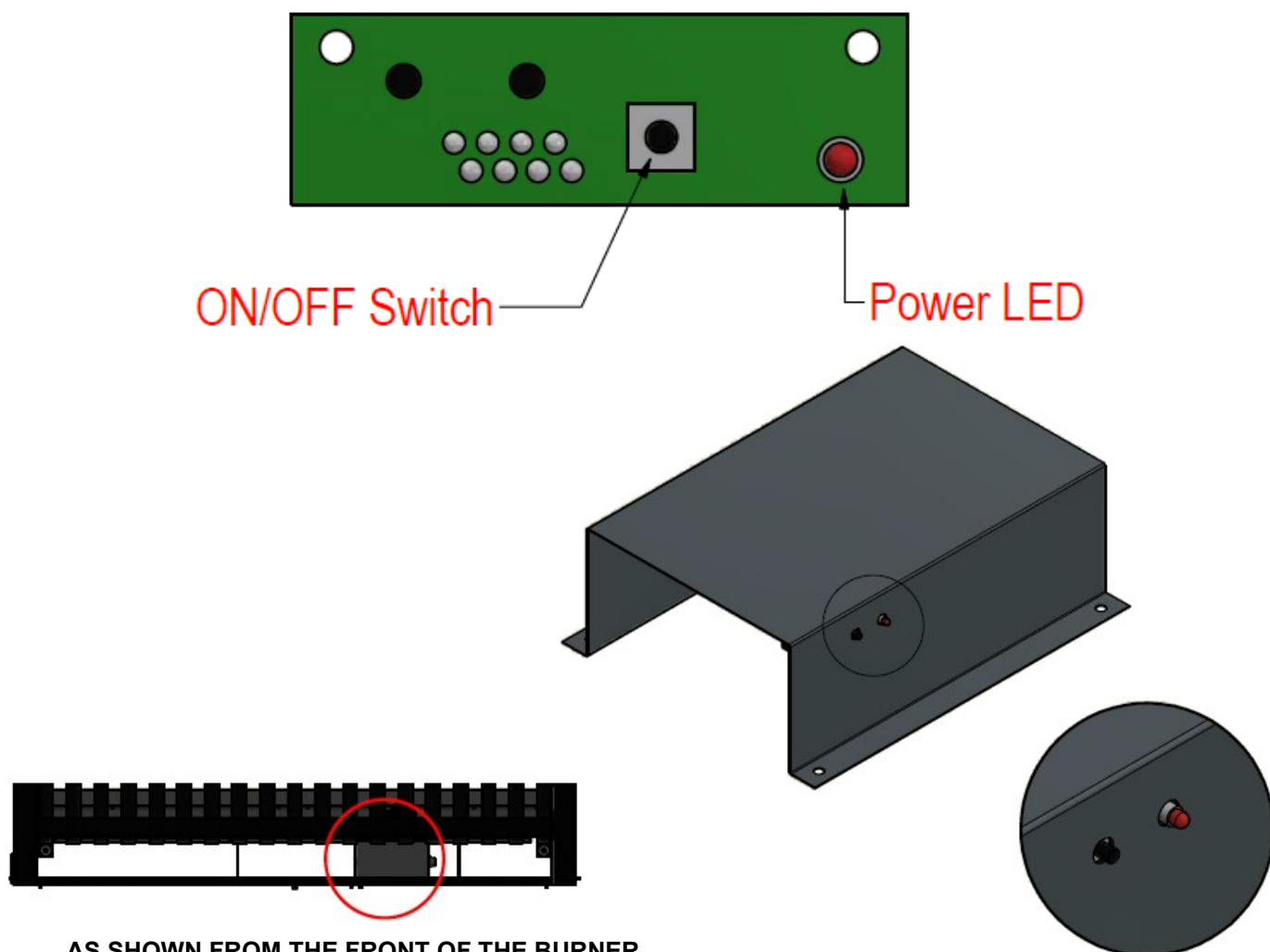

The switch is located behind the grate on the control valve heat shield as shown above.

Press and release the power button. This will start the electronic spark and the power LED will be on permanently. The pilot will ignite first and once this is on, it will ignite the main burner. Pressing and releasing the power button again will switch off the appliance.

When the appliance is turned on, the gas fire will be set to medium flame and fan setting.

If the gas fails to light, the appliance will go into lock out mode. To start the appliance again turn appliance off and wait 3 minutes before turning it on.

Please note that the power button is for use when the remote controller is lost or damaged and can't be used. This controller can not adjust flame height or fan speed, hence is supplied for emergency use, if remote and phone App is not able to be used.

PROCEDURE FOR THE TEST AND COMISSIONING OF YOUR DECORATIVE FIRE

Ensure Gas Supply and the Power Supply (caution 240V) to the Unit

- Refer to Data Plate on this specification for settings. The Data plate is attached to the under carriage of the Burner.
- Remove front grate.
- Loosen the Jet test point and attach manometer (digital is preferred). The test point is on the right hand side of the gas burner, as shown below:

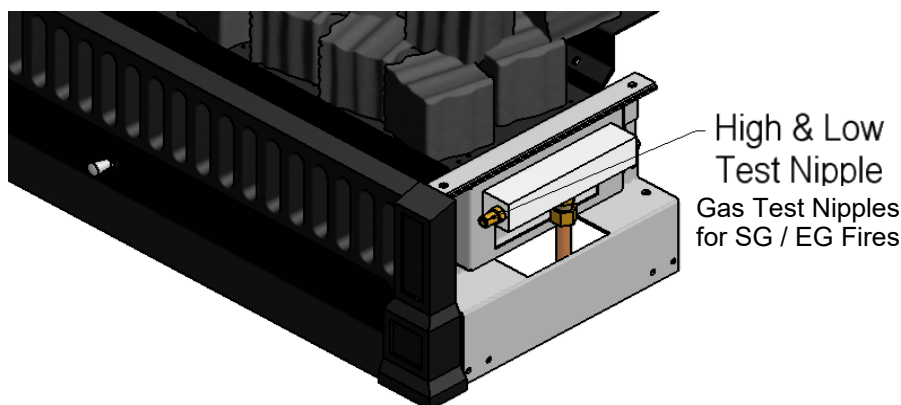

Note : Location of the Test Nipple - may vary from Model to Model

- Light appliance, adjust to high flame setting and check pressure, adjust to low flame and check pressure.

NOTE: Any alterations to pressure is to be carried out by a Certified Gasfitter

- If adjustments are necessary, remove the cap. The Pressure Adjustment screw and nut are on the front side of the Gas Control Valve (shown in diagram **B** in this specification) and are **factory** set.

High Pressure Setting: Set the modulator to maximum condition. Screw in **Nut A** to increase the outlet pressure then screw nut A out to decrease the pressure to the desired settings. Use 10mm spanner.

Low Pressure Setting: Turn off the power to the modulator (by disconnecting the modulator harness connection at the valve - see wiring) and keep nut A stationary. Use a screwdriver to screw in **Screw B** to increase the pressure and screw it out to decrease the pressure. Carefully replace the modulator plastic cap.

WARNING: To ensure the correct operation of the modulator it is necessary that the plastic cap is returned to its original location.

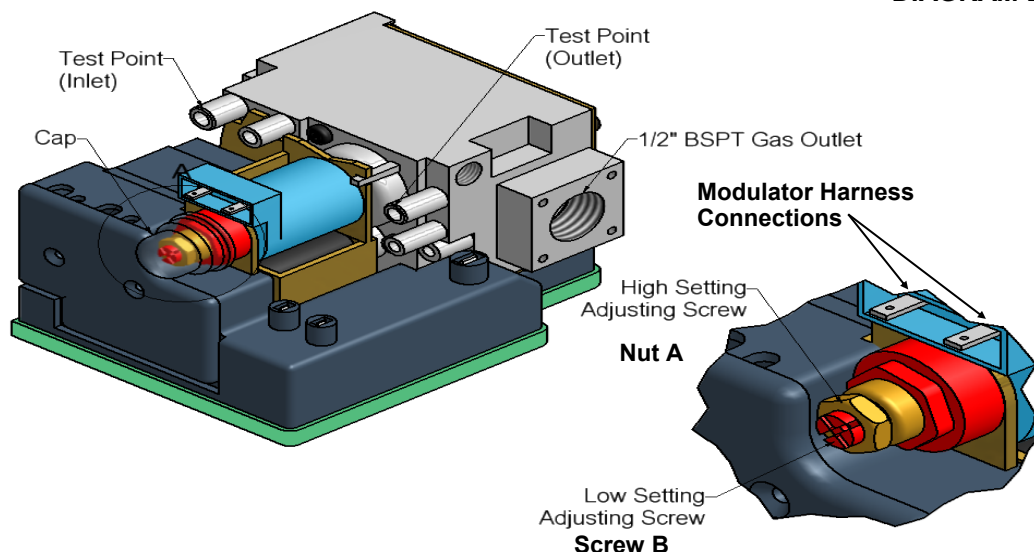
DIAGRAM B (SHOWING CONTROL VALVE WITH TEST POINTS AND ADJUSTING SCREW)
Modulator Harness Connections
DIAGRAM B

- After checking the pressure, turn the unit off, remove manometer from the test point and tighten the test point screw. Ensure to check for gas leaks.
- Ensure Power is off & reconnect Modulator Harness Connection in the main harness. See **Diagram B** above.
- Turn the appliance on and off a few times to check ignition.
- When you are satisfied that the appliance is working correctly, fit the front panel assembly back to the gas burner.
- **NOTE:** Ensure you peel the Protective Plastic Coating from any stainless steel components if fitted.
- All Burner aerations are Factory preset and cannot be adjusted.
- If you are unable to get the unit to operate correctly, refer to troubleshooting before contacting your Local Service Contact.
- It may take approximately 2 hours of operation for the coals/logs or river rocks to achieve their full flame pattern and glow.
- During the Initial Burn period, some smoke and smell may be experienced. Because of this, run the appliance on the high position in a well ventilated room until the fumes dissipate .

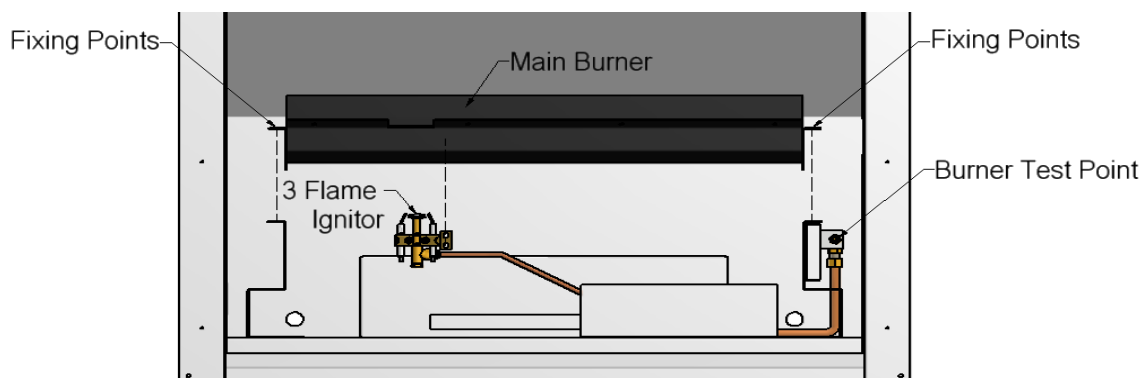

FULLY MODULATING (SIT 845) - WIRING DIAGRAM

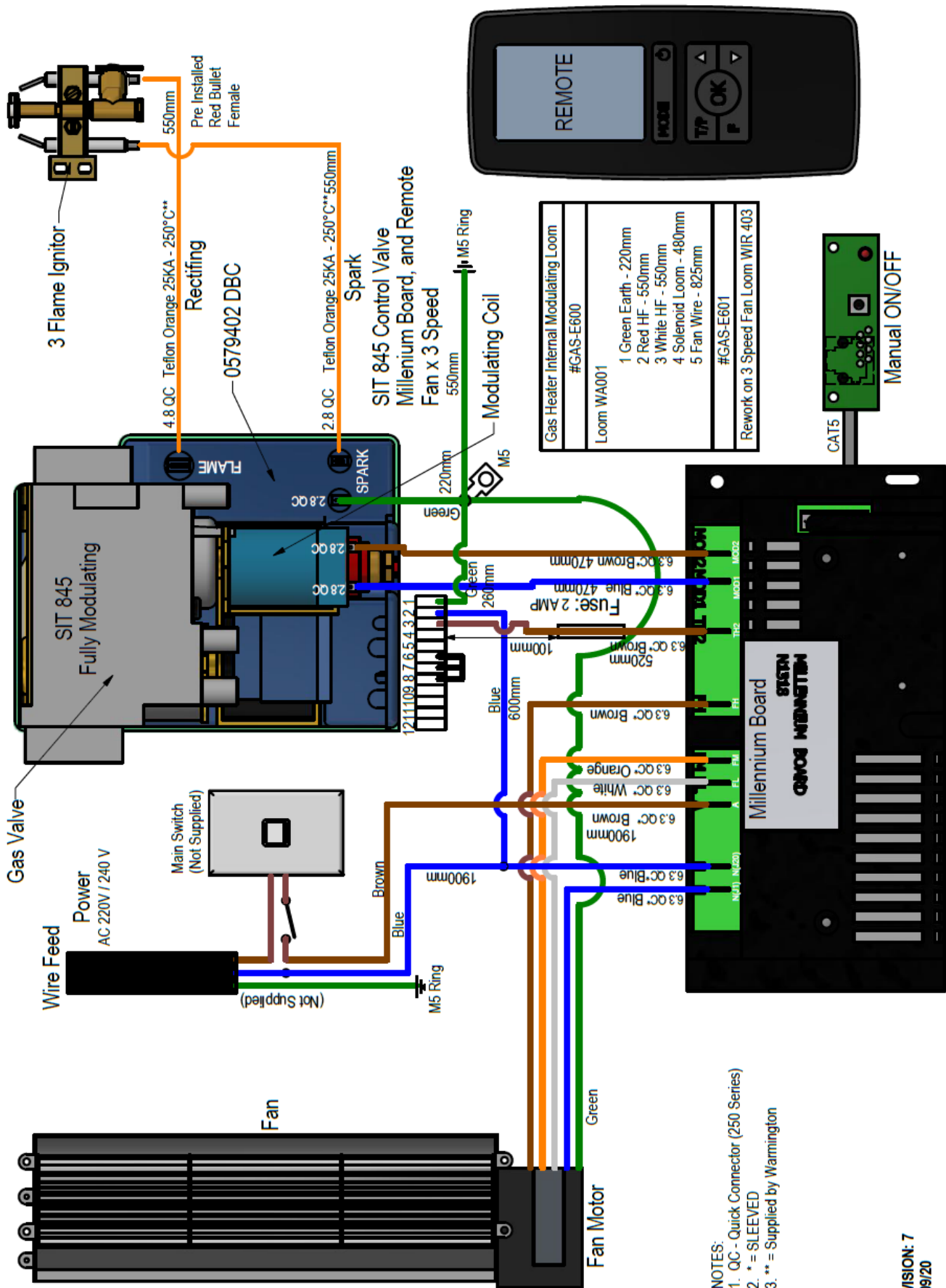

REVISION: 7
03/09/20

GENERAL NOTES

NOTES:

- These installation and operating instructions should be kept in a safe place. Should you require another copy, download from the **Warmington** website www.warmington.co.nz.
- Warranty - for full details on product warranties, contact your local Authorised Warmington Retailer.
- Correct installation, operation and maintenance must be maintained to comply with the **Warmington** Warranty.
- The appliance and flue system must be installed in accordance with relevant standards and the appropriate building codes.
- This appliance must be serviced annually and any service operation must be carried out by a qualified service person.

WARNINGS:

- **WARNING: ANY MODIFICATION OF THE APPLIANCE THAT HAS NOT BEEN APPROVED IN WRITING BY THE TESTING AUTHORITY IS CONSIDERED A BREACH OF NZ STANDARDS.**
- **WARNING: DO NOT USE OR STORE FLAMMABLE LIQUIDS OR AEROSOLS IN THE VICINITY OF THIS APPLIANCE WHILST IN OPERATION.**
- **WARNING; DO NOT PLACE FLAMMABLE MATERIALS ON OR AGAINST THIS APPLIANCE.**
- **CAUTION:** THIS APPLIANCE SHOULD BE MAINTAINED AND OPERATED AT ALL TIMES IN ACCORDANCE WITH THESE INSTRUCTIONS.
- **CAUTION:** ALL SERVICING MUST BE CARRIED OUT BY AN AUTHORISED SERVICE TECHNICIAN.
- **CAUTION:** MAKE SURE THE USE OF CORRECT FUEL TYPE WITH THIS APPLIANCE.

NOTE: Keep a copy of these instructions for operating and maintenance guidelines.



Industries 1994 LTD
PO Box 58652, Botany 2163, Auckland
www.warmington.co.nz