

Warmington Gas Open Fire

Trieste (Three Sided 1 Long 2 Short) 1600 Firebox

Fire, Flue System to Comply with NZS 5261 / 5262 : 2003

Due to continued product improvement, Warmington Ind LTD reserves the right to change product specifications without prior notification.

Read all the Instructions carefully before commencing the Installation. Failure to follow these instructions may result in a fire hazard and void the warranty

For Specification See: www.warmington.co.nz

Copyright ©

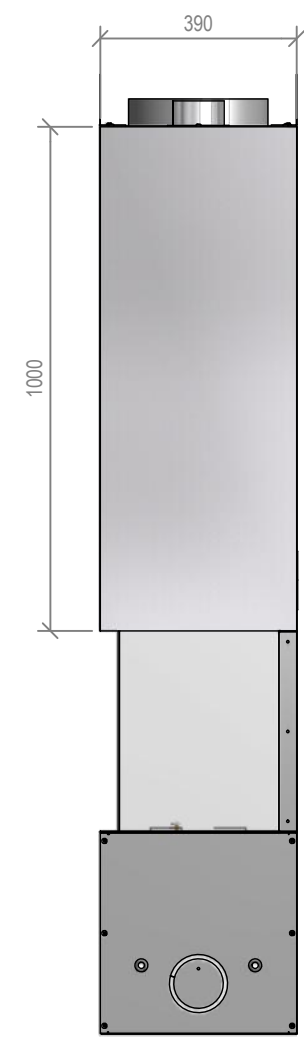
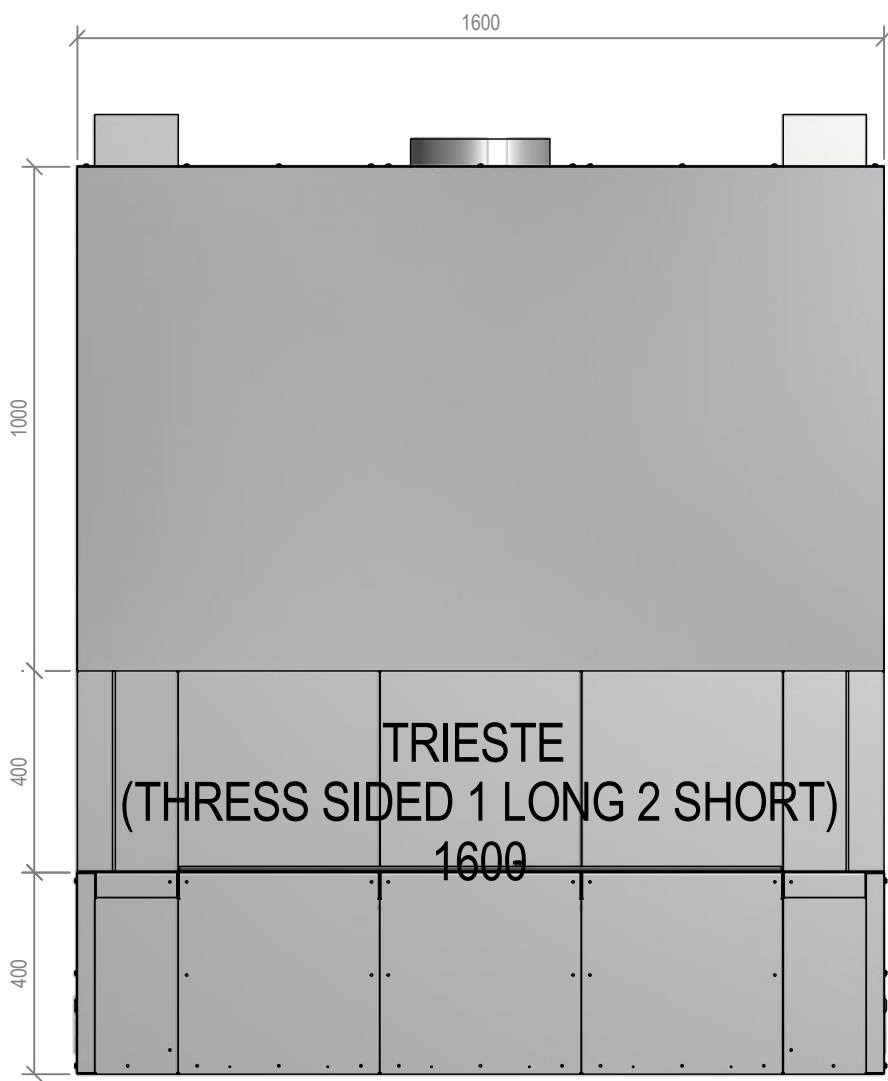

Warmington Industries Ltd.	
PH: 09 273 9227 FAX: 09 273 9241 WEB: www.warmington.co.nz	
TITLE	TRIESTE (THREE SIDED 1 LONG 2 SHORT) 1600 FIREBOX
DRAWN	ROBERT
DATE	15/10/15
SCALE	NOT TO SCALE
REVISION	01

Warmington Gas Open Fire

Trieste (Three Sided 1 Long 2 Short) 1600 Timber Framing

Fire, Flue System to Comply with NZS 5261 / 5262 : 2003

Due to continued product improvement, Warmington Ind LTD reserves the right to change product specifications without prior notification.

Read all the Instructions carefully before commencing the Installation. Failure to follow these instructions may result in a fire hazard and void the warranty

For Specification See: www.warmington.co.nz
Copyright ©

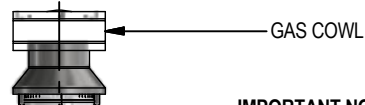
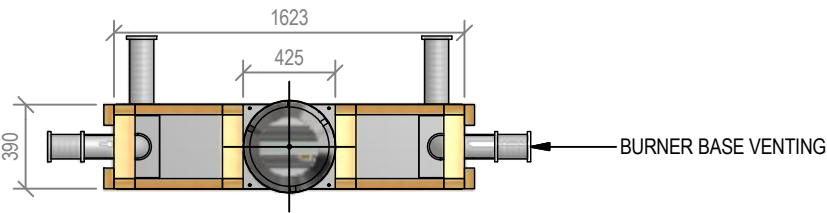

IMPORTANT NOTE:
WHERE AN INTERNAL WALL BOARD FINISH IS REQUIRED AROUND THE FIREPLACE, ENSURE ALLOWANCE IS MADE TO PLACE NON COMBUSTIBLE INTERNAL WALL LINING (e.g. PROMINA ETERPAN, SUPALUX) TO COVER THE EXTENT OF THE HEBEL BLOCK SURROUND

DIRECTLY TOUCHING THE FIREBOX WITH ANY BOARD OR PLASTER MAY CAUSE CRACKING FROM HEAT EXPANSION
ALLOW 3mm MINIMUM SPACE AWAY FROM THE FIREBOX

Ø275/325 FLUE SYSTEM

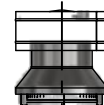
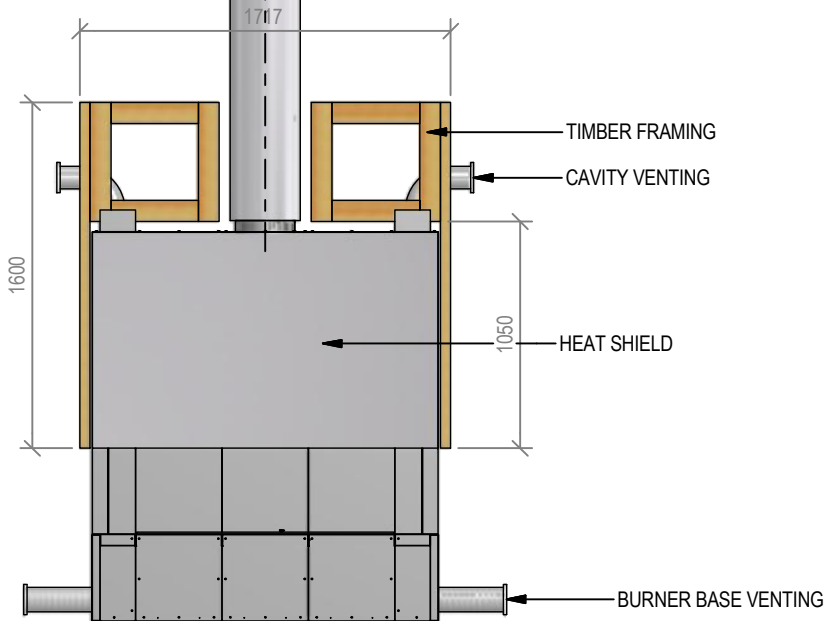

Ø325 GALV LINER

Ø275 STAINLESS STEEL FLUE

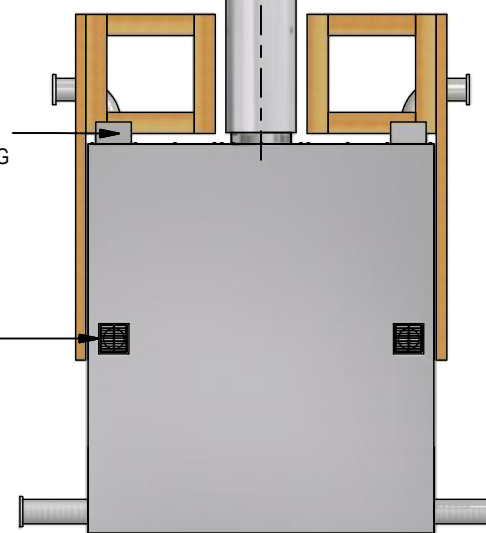
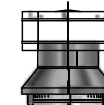
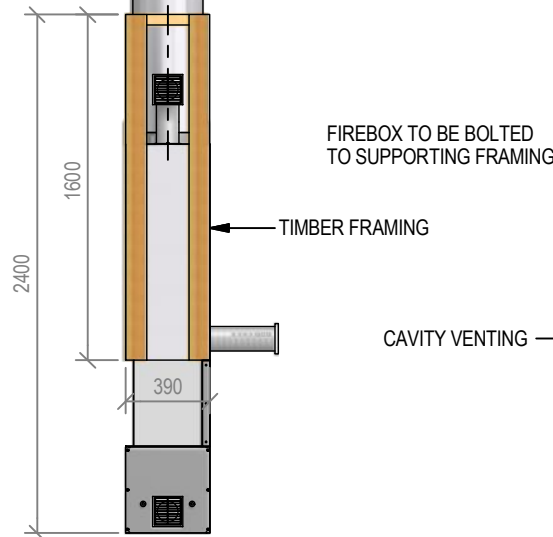

Warmington Industries Ltd.		PH: 09 273 9227 FAX: 09 273 9241 WEB: www.warmington.co.nz	
TITLE	TRIESTE (THREE SIDED 1 LONG 2 SHORT) 1600 TIMBER FRAMING	DATE	15/10/15
DRAWN	ROBERT	REVISION	01
SCALE	NOT TO SCALE		